

SMITH CREEK RESIDENTIAL DEVELOPMENT

EXHIBIT Y - 1

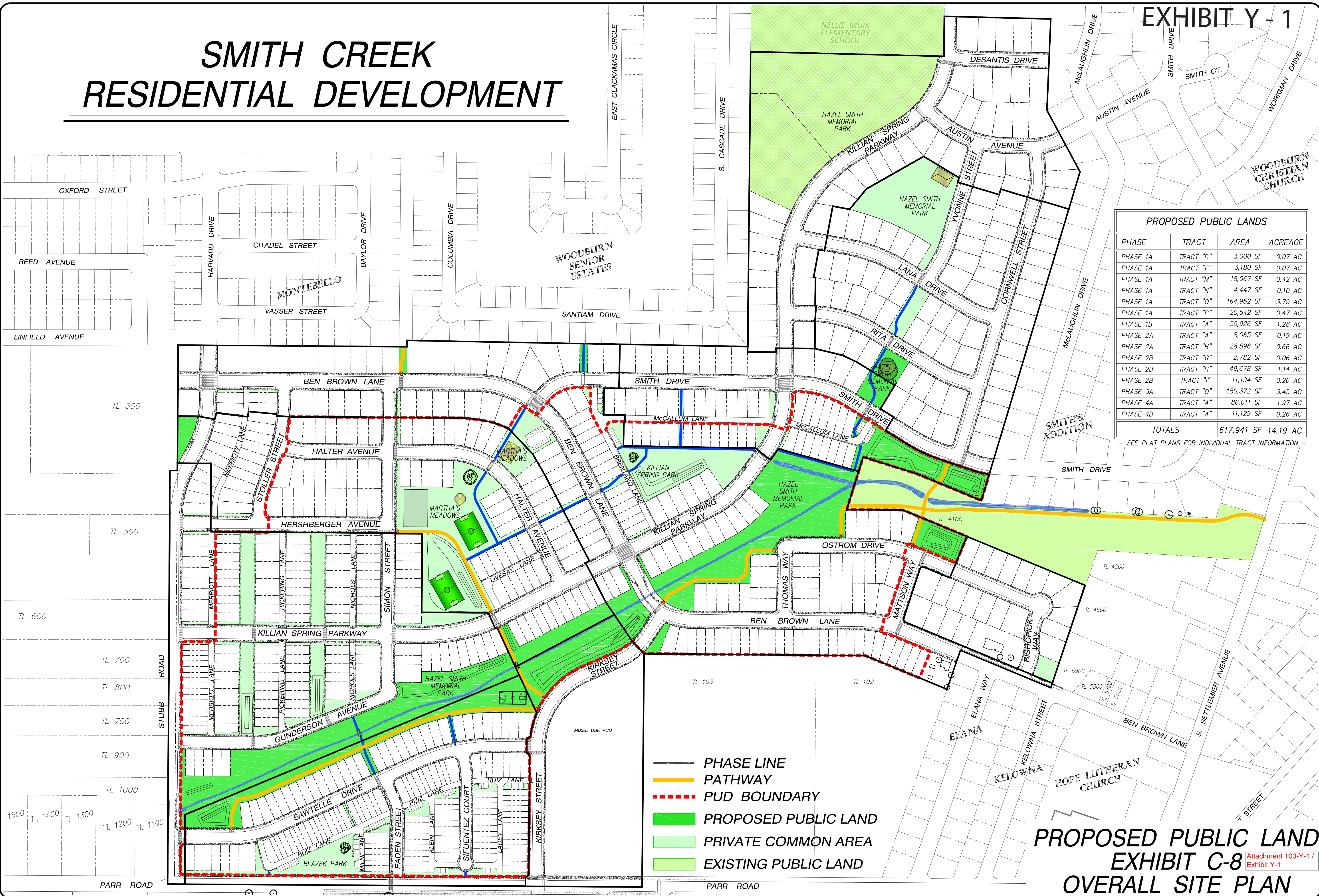

PROPOSED PUBLIC LANDS

| PHASE | TRACT | AREA | ACREAGE |
|---------------|-----------|-------------------|-----------------|
| PHASE 1A | TRACT "D" | 3,000 SF | 0.07 AC |
| PHASE 1A | TRACT "F" | 3,180 SF | 0.07 AC |
| PHASE 1A | TRACT "M" | 18,067 SF | 0.42 AC |
| PHASE 1A | TRACT "N" | 4,447 SF | 0.10 AC |
| PHASE 1A | TRACT "O" | 164,952 SF | 3.79 AC |
| PHASE 1A | TRACT "P" | 20,542 SF | 0.47 AC |
| PHASE 1B | TRACT "A" | 55,926 SF | 1.28 AC |
| PHASE 2A | TRACT "A" | 8,065 SF | 0.19 AC |
| PHASE 2A | TRACT "H" | 28,596 SF | 0.66 AC |
| PHASE 2B | TRACT "G" | 2,782 SF | 0.06 AC |
| PHASE 2B | TRACT "H" | 49,678 SF | 1.14 AC |
| PHASE 2B | TRACT "I" | 11,194 SF | 0.26 AC |
| PHASE 3A | TRACT "O" | 150,372 SF | 3.45 AC |
| PHASE 4A | TRACT "A" | 86,011 SF | 1.97 AC |
| PHASE 4B | TRACT "A" | 11,129 SF | 0.26 AC |
| TOTALS | | 617,941 SF | 14.19 AC |

SEE PLAT PLANS FOR INDIVIDUAL TRACT INFORMATION

- PHASE LINE
- PATHWAY
- - - PUD BOUNDARY
- PROPOSED PUBLIC LAND
- PRIVATE COMMON AREA
- EXISTING PUBLIC LAND

PROPOSED PUBLIC LAND EXHIBIT C-8 OVERALL SITE PLAN

TAX MAP 52W13 - LOT 100
TAX MAP 52W13BD - LOTS 100 & 200
TAX MAP 51W18BC - LOT 4000
MARION COUNTY
CITY OF WOODBURN, OREGON

STAFFORD
DEVELOPMENT COMPANY, LLC
485 SOUTH STATE STREET
LAKE OSWEGO, OREGON 97034

SMITH CREEK
RESIDENTIAL DEVELOPMENT
AUGUST, 2018

| NO. | DATE | DESCRIPTION |
|-----|------|-------------|
| | | |

PLANNING & LAND DESIGN
1862 NE ESTATE DRIVE
HILLSBORO, OREGON 97124
RYAN O'BRIEN
(503) 780-4061

SHEET
1
OF
1