



March 26, 2020

Morgan Will
Development Manager, Acquisitions & Development
Stafford Development Co., LLC
8840 SW Holly Lane
Wilsonville, OR 97070-9800

RE: Smith Creek Phase 1A & City stormwater tract (Tax Lots 052W13 00108 & 051W18BC 04100) final plans:
public common area signage approval

Dear Mr. Will:

Staff reviewed the public common area signage plan related to Condition G5 "final plan", subsection b., and tied to Phase 1A.

Confirming that the Assistant City Administrator had agreed to the public common area signage plan that notes signage for wayfinding, flood zone, park use hours, and dog waste stations, the Planning Division approves it with redlines omitting references to private subdivision monument signage.

Enclosed is a copy of the approved plan. Staff also uploaded an Adobe PDF of this letter with the plans to the [City project webpage](#).

Staff looks forward to installation, which staff understands would among the public improvements and their construction by end of May 2020, and inspection in concert with approved civil engineering plans.

Please contact me at (503) 980-2485 or <colin.cortes@ci.woodburn.or.us> with questions.

Sincerely,

A handwritten signature in blue ink that reads 'Colin Cortes'.

Colin Cortes, AICP, CNU-A
Senior Planner





Enclosure: Approved public common area signage plan (2 sheets; March 26, 2020)

cc: Chris Kerr, AICP, Community Development Director
Dago Garcia, P.E., City Engineer

SMITH CREEK RESIDENTIAL DEVELOPMENT

OVERALL SIGNAGE PLAN

 MONUMENT SIGN LOCATION Private subdivision monument signage is excluded from this approval of public common area signage.

-  WAYFINDING SIGN
-  FLOOD ZONE WARNING SIGN
-  PARK USE HOURS SIGN
-  DOG WASTE STATION SIGN

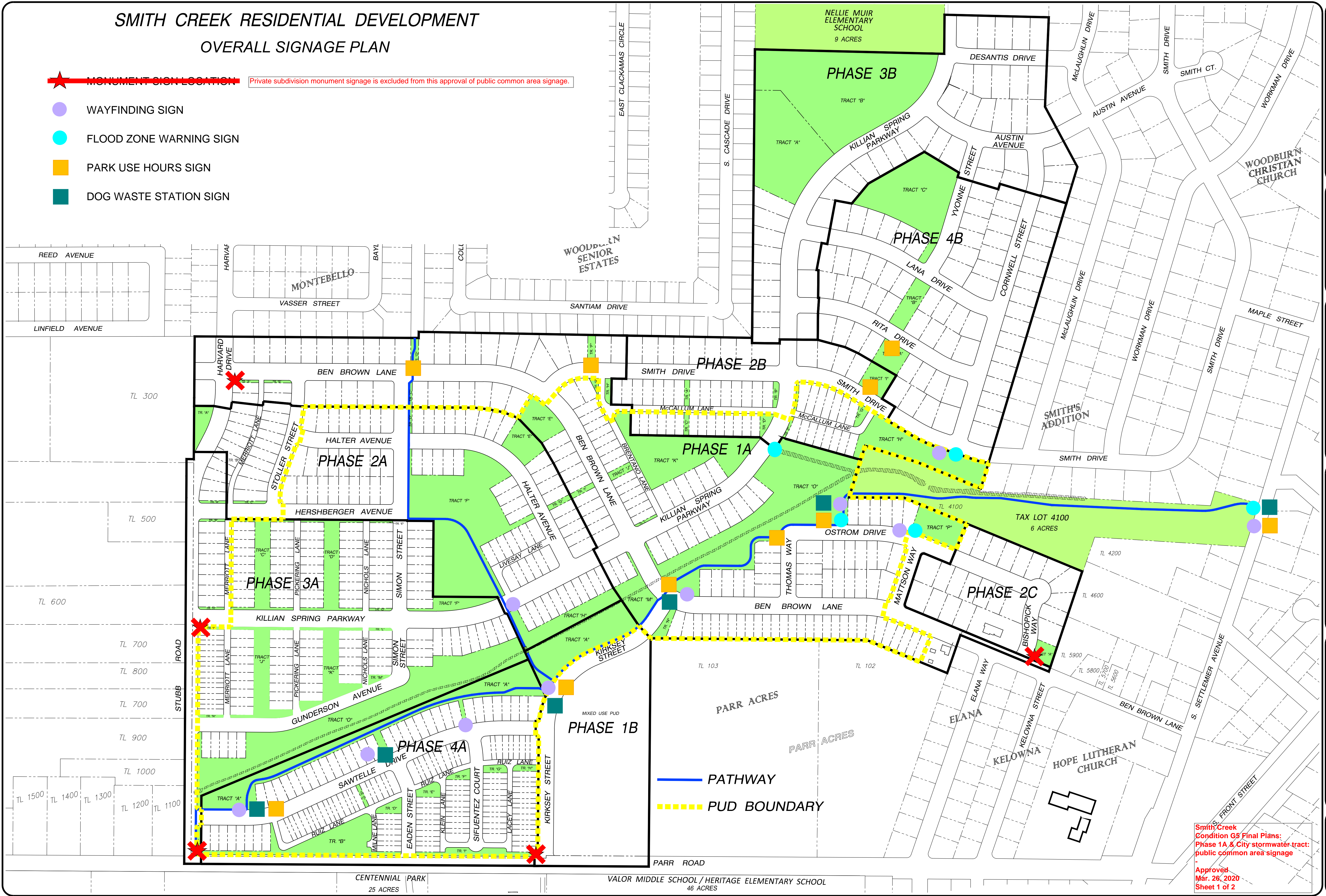

SMITH CREEK
RESIDENTIAL DEVELOPMENT

NO. DATE DESCRIPTION

OIO OTTEN & ASSOCIATES
LANDSCAPE ARCHITECTURE, LLC
3933 SW Kelly Avenue • Suite B • Portland, OR 97239
Phone: (503)972-0311 • oio@oia.com

SHEET

1 OF 1

Smith Creek
Condition G5 Final Plans:
Phase 1A & City stormwater tract:
public common area signage
Approved
Mar. 26, 2020
Sheet 1 of 2



TYPICAL WAYFINDING SIGN
NOT TO SCALE



TYPICAL PARK USE SIGN
NOT TO SCALE



TYPICAL DOG WASTE STATION SIGN
NOT TO SCALE

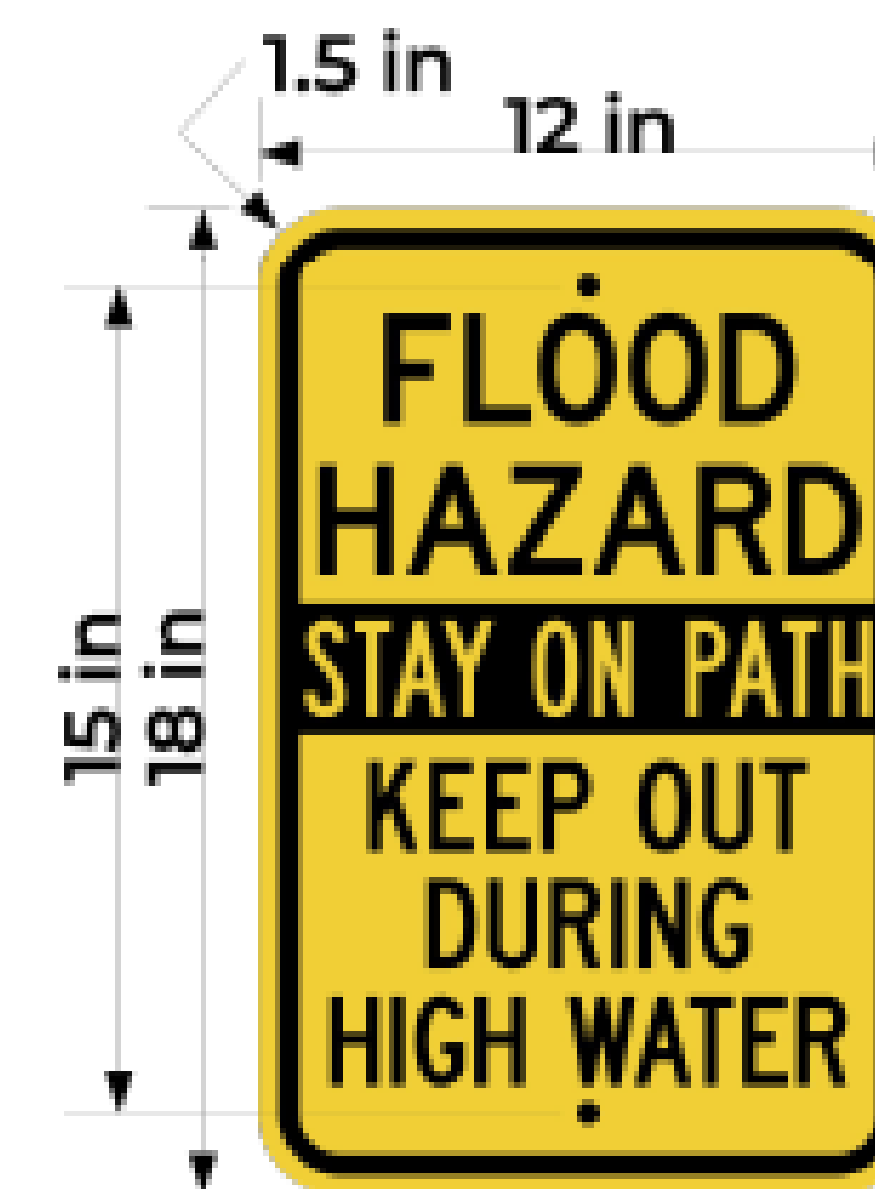

TYPICAL FLOOD HAZARD SIGN
NOT TO SCALE

Smith Creek
Condition G5 Final Plans:
Phase 1A & City stormwater tract:
public common area signage
-
Approved
Mar. 26, 2020
Sheet 2 of 2

SMITH CREEK
RESIDENTIAL DEVELOPMENT

NO. DATE DESCRIPTION

OIO OTTEN & ASSOCIATES
LANDSCAPE ARCHITECTURE, LLC
3933 SW Kelly Avenue • Suite B • Portland, OR 97239
phone: (503)972-0311 • ottenla.com

SHEET

2 OF 2