



NOTICE TO EXCAVATORS: ATTENTION: OREGON LAW REQUIRES YOU TO FOLLOW RULES ADOPTED BY THE OREGON UTILITY NOTIFICATION CENTER. THOSE RULES ARE SET FORTH IN OAR 952-001-0010 THROUGH OAR 952-001-0090. YOU MAY OBTAIN COPIES OF THE RULES BY CALLING THE CENTER. (NOTE: THE TELEPHONE NUMBER FOR THE OREGON UTILITY NOTIFICATION CENTER IS (503)-232-1987).

POTENTIAL UNDERGROUND FACILITY OWNERS
DIG SAFELY
CALL THE OREGON ONE-CALL CENTER
1-800-332-2344

EMERGENCY TELEPHONE NUMBERS

NW NATURAL GAS
M-F 7am-5pm 503-226-4211 EXT.4313
AFTER HOURS 503-226-4211

PGE 503-464-7777
QWEST 1-800-573-1311
VERIZON 1-800-483-1000

GENERAL NOTES

- CONSTRUCTION LAYOUT (ALL ACTUAL LINES AND GRADES) SHALL BE STAKED BY A PROFESSIONAL SURVEYOR, REGISTERED IN THE STATE OF OREGON, BASED ON COORDINATES, DIMENSIONS, BEARINGS, AND ELEVATIONS, AS SHOWN, ON THE PLANS.
- PROJECT CONTROL SHALL BE FIELD VERIFIED AND CHECKED FOR RELATIVE HORIZONTAL POSITION PRIOR TO BEGINNING CONSTRUCTION LAYOUT.
- PROJECT CONTROL SHALL BE FIELD VERIFIED AND CHECKED FOR RELATIVE VERTICAL POSITION BASED ON THE BENCHMARK STATED HEREON, PRIOR TO BEGINNING CONSTRUCTION LAYOUT.
- WHEN DIMENSIONS AND COORDINATE LOCATIONS ARE REPRESENTED - DIMENSIONS SHALL HOLD OVER COORDINATE LOCATION, NOTIFY THE CIVIL ENGINEER OF RECORD IMMEDIATELY UPON DISCOVERY.
- BUILDING SETBACK DIMENSIONS FROM PROPERTY LINES SHALL HOLD OVER ALL OTHER CALLOUTS. PROPERTY LINES AND ASSOCIATED BUILDING SETBACKS SHALL BE VERIFIED PRIOR TO CONSTRUCTION LAYOUT.
- CONTRACTOR SHALL PRESERVE AND PROTECT FROM DAMAGE ALL EXISTING MONUMENTATION DURING CONSTRUCTION. THE CONTRACTOR IS RESPONSIBLE FOR COORDINATING AND PAYING FOR THE REPLACEMENT OF ANY MONUMENTS DAMAGED OR REMOVED DURING CONSTRUCTION. NEW MONUMENTS SHALL BE REESTABLISHED BY A LICENSED SURVEYOR.
- ALL CONSTRUCTION AND MATERIALS SHALL CONFORM TO THESE PLANS, THE PROJECT SPECIFICATIONS AND THE APPLICABLE REQUIREMENTS OF THE 2024 OREGON STANDARD SPECIFICATIONS FOR CONSTRUCTION, THE 2023 OREGON PLUMBING SPECIALTY CODE AND LOCAL JURISDICTION REQUIREMENTS.
- THE COMPLETED INSTALLATION SHALL CONFORM TO ALL APPLICABLE FEDERAL, STATE, AND LOCAL CODES, ORDINANCES AND REGULATIONS. ALL PERMITS, LICENSES AND INSPECTIONS REQUIRED BY THE GOVERNING AUTHORITIES FOR THE EXECUTION AND COMPLETION OF WORK SHALL BE SECURED BY THE CONTRACTOR PRIOR TO COMMENCING CONSTRUCTION.
- ATTENTION: OREGON LAW REQUIRES YOU TO FOLLOW RULES ADOPTED BY THE OREGON UTILITY NOTIFICATION CENTER. THOSE RULES ARE SET FORTH IN OAR 952-001-0010 THROUGH OAR 952-001-0090. YOU MAY OBTAIN COPIES OF THE RULES BY CALLING THE CENTER. (NOTE: THE TELEPHONE NUMBER FOR THE OREGON UTILITY NOTIFICATION CENTER IS (503) 232-1987). EXCAVATORS MUST NOTIFY ALL PERTINENT COMPANIES OR AGENCIES WITH UNDERGROUND UTILITIES IN THE PROJECT AREA AT LEAST 48 BUSINESS-DAY HOURS, BUT NOT MORE THAN 10 BUSINESS DAYS PRIOR TO COMMENCING AN EXCAVATION, SO UTILITIES MAY BE ACCURATELY LOCATED.
- THE LOCATION OF EXISTING UNDERGROUND UTILITIES SHOWN ON THE PLANS ARE FOR INFORMATION ONLY AND ARE NOT GUARANTEED TO BE COMPLETE OR ACCURATE. CONTRACTOR SHALL VERIFY ELEVATIONS, PIPE SIZE, AND MATERIAL TYPES OF ALL UNDERGROUND UTILITIES PRIOR TO COMMENCING WITH CONSTRUCTION AND SHALL BRING ANY DISCREPANCIES TO THE ATTENTION OF AAI ENGINEERING, 72 HOURS PRIOR TO START OF CONSTRUCTION TO PREVENT GRADE AND ALIGNMENT CONFLICTS.
- THE ENGINEER OR OWNER IS NOT RESPONSIBLE FOR THE SAFETY OF THE CONTRACTOR OR HIS CREW. ALL O.S.H.A. REGULATIONS SHALL BE STRICTLY ADHERED TO IN THE PERFORMANCE OF THE WORK.
- TEMPORARY AND PERMANENT EROSION CONTROL MEASURES SHALL BE IMPLEMENTED. THE ESC FACILITIES SHOWN IN THESE PLANS ARE THE MINIMUM REQUIREMENTS FOR ANTICIPATED SITE CONDITIONS. DURING THE CONSTRUCTION PERIOD, ESC FACILITIES SHALL BE UPGRADED AS NEEDED FOR UNEXPECTED STORM EVENTS AND TO ENSURE THAT SEDIMENT AND SEDIMENT LADEN WATER DO NOT LEAVE THE SITE.
- THE CONTRACTOR IS RESPONSIBLE FOR MAINTAINING ALL ROADWAYS, KEEPING THEM CLEAN AND FREE OF CONSTRUCTION MATERIALS AND DEBRIS, AND PROVIDING DUST CONTROL AS REQUIRED.
- TRAFFIC CONTROL SHALL BE PROVIDED BY THE CONTRACTOR THROUGHOUT CONSTRUCTION. CONTRACTOR SHALL PROVIDE A TRAFFIC CONTROL PLAN TO LOCAL JURISDICTION FOR REVIEW AND APPROVAL PRIOR TO COMMENCING CONSTRUCTION.
- THE CONTRACTOR SHALL BE RESPONSIBLE FOR COORDINATING AND SCHEDULING ALL WORK WITH THE OWNER.
- THE CONTRACTOR SHALL HAVE A FULL SET OF THE CURRENT APPROVED CONSTRUCTION DOCUMENTS INCLUDING ADDENDA ON THE PROJECT SITE AT ALL TIMES.
- THE CONTRACTOR SHALL KEEP THE ENGINEER AND JURISDICTION INFORMED OF CONSTRUCTION PROGRESS TO FACILITATE SITE OBSERVATIONS AT REQUIRED INTERVALS. 24-HOUR NOTICE IS REQUIRED.
- EXISTING SURVEY MONUMENTS ARE TO BE PROTECTED DURING CONSTRUCTION OR REPLACED IN ACCORDANCE WITH OREGON REVISED STATUTES 209.140 - 209.155.

CONSTRUCTION NOTES

DEMOLITION

- THE CONTRACTOR SHALL BE RESPONSIBLE FOR DEMOLITION AND DISPOSAL OF EXISTING AC, CURBS, SIDEWALKS AND OTHER SITE ELEMENTS WITHIN THE SITE AREA IDENTIFIED IN THE PLANS.
- EXCEPT FOR MATERIALS INDICATED TO BE STOCKPILED OR TO REMAIN ON OWNER'S PROPERTY, CLEARED MATERIALS SHALL BECOME CONTRACTOR'S PROPERTY, REMOVED FROM THE SITE, AND DISPOSED OF PROPERLY.
- ITEMS INDICATED TO BE SALVAGED SHALL BE CAREFULLY REMOVED AND DELIVERED STORED AT THE PROJECT SITE AS DIRECTED BY THE OWNER.
- ALL LANDSCAPING, PAVEMENT, CURBS AND SIDEWALKS, BEYOND THE IDENTIFIED SITE AREA, DAMAGED DURING THE CONSTRUCTION SHALL BE REPLACED TO THEIR ORIGINAL CONDITION OR BETTER.
- CONCRETE SIDEWALKS SHOWN FOR DEMOLITION SHALL BE REMOVED TO THE NEAREST EXISTING CONSTRUCTION JOINT.
- SAWCUT STRAIGHT MATCHLINES TO CREATE A BUTT JOINT BETWEEN THE EXISTING AND NEW PAVEMENT.

UTILITIES

- ADJUST ALL INCIDENTAL STRUCTURES, MANHOLES, VALVE BOXES, CATCH BASINS, FRAMES AND COVERS, ETC. TO FINISHED GRADE.
- CONTRACTOR SHALL ADJUST ALL EXISTING AND/OR NEW FLEXIBLE UTILITIES (WATER, TV, TELEPHONE, ELEC., ETC.) TO CLEAR ANY EXISTING OR NEW GRAVITY DRAIN UTILITIES (STORM DRAIN, SANITARY SEWER, ETC.) IF CONFLICT OCCURS.
- CONTRACTOR SHALL COORDINATE WITH PRIVATE UTILITY COMPANIES FOR THE INSTALLATION OF OR ADJUSTMENT TO GAS, ELECTRICAL, POWER AND TELEPHONE SERVICE.
- BEFORE BACKFILLING ANY SUBGRADE UTILITY IMPROVEMENTS CONTRACTOR SHALL SURVEY AND RECORD MEASUREMENTS OF EXACT LOCATION AND DEPTH AND SUBMIT TO ENGINEER AND OWNER.

STORM AND SANITARY

- CONNECTIONS TO EXISTING STORM AND SANITARY SEWERS SHALL CONFORM TO THE 2024 OREGON STANDARD SPECIFICATIONS FOR CONSTRUCTION, SECTION 00490, "WORK ON EXISTING SEWERS AND STRUCTURES".
- BEGIN LAYING STORM DRAIN AND SANITARY SEWER PIPE AT THE LOW POINT OF THE SYSTEM, TRUE TO GRADE AND ALIGNMENT INDICATED WITH UNBROKEN CONTINUITY OF INVERT. THE CONTRACTOR SHALL ESTABLISH LINE AND GRADE FOR THE STORM AND SANITARY SEWER PIPE USING A LASER.
- ALL ROOF DRAIN AND CATCH BASIN LEADERS SHALL HAVE A MINIMUM SLOPE OF 1 PERCENT UNLESS NOTED OTHERWISE IN THE PLANS.
- ALL STORM AND SANITARY FITTINGS TO BE ECCENTRIC FITTINGS UNLESS OTHERWISE NOTED.

WATER

- ALL WATER AND FIRE PROTECTION PIPE SHALL HAVE A MINIMUM 36-INCH COVER TO THE FINISH GRADE.
- ALL WATER AND FIRE PRESSURE FITTINGS SHALL BE PROPERLY RESTRAINED WITH THRUST BLOCKS PER DETAIL.
- ALL WATER MAIN / SANITARY SEWER CROSSINGS SHALL CONFORM TO THE OREGON STATE HEALTH DEPARTMENT REGULATIONS, CHAPTER 333.

EARTHWORKS

- CONTRACTOR SHALL PREVENT SEDIMENTS AND SEDIMENT LADEN WATER FROM ENTERING THE STORM DRAINAGE SYSTEM.
- TRENCH BEDDING AND BACKFILL SHALL BE AS SHOWN ON THE PIPE BEDDING AND BACKFILL DETAIL. THE PROJECT SPECIFICATIONS AND AS REQUIRED IN THE SOILS REPORT. FLOODING OR JETTING THE BACKFILLED TRENCHES WITH WATER WILL NOT BE PERMITTED.
- SUBGRADE AND TRENCH BACKFILL SHALL BE COMPACTED TO AT LEAST 95% OF THE MAXIMUM DRY DENSITY AS DETERMINED BY ASTM D-698. FLOODING OR JETTING THE BACKFILLED TRENCHES WITH WATER IS NOT PERMITTED.

PAVING

- SEE ARCHITECTURAL PLANS FOR SIDEWALK FINISHING AND SCORING PATTERNS.

MATERIAL NOTES

- GENERAL: MATERIALS SHALL BE NEW. THE USE OF MANUFACTURER'S NAMES, MODELS, AND NUMBERS IS INTENDED TO ESTABLISH STYLE, QUALITY, APPEARANCE, AND USEFULNESS. PROPOSED SUBSTITUTIONS WILL REQUIRE WRITTEN APPROVAL FROM ENGINEER PRIOR TO INSTALLATION.
- STORM AND SANITARY SEWER PIPING SHALL BE PVC PIPE AS INDICATED IN THE PLANS. PIPES WITH LESS THAN 2' OF COVER SHALL BE C900/C905 PVC, HDPE OR DUCTILE IRON PIPE.
- PRIVATE WATER MAINS 4-INCH DIAMETER AND LARGER SHALL BE DUCTILE IRON PIPE SCH 52 OR C900; AS INDICATED IN THE PLANS.
- PRIVATE WATER LINES 3-INCH DIAMETER AND SMALLER SHALL BE TYPE K COPPER OR PVC; AS INDICATED IN THE PLANS.
- CONCRETE FOR CURBS, SIDEWALK AND DRIVEWAYS SHALL HAVE A MINIMUM COMPRESSIVE STRENGTH OF 3,500 PSI AT 28 DAYS.

SEPARATION STATEMENT

ALL WATER MAIN CROSSINGS SHALL CONFORM TO THE OREGON STATE HEALTH DEPARTMENT, CHAPTER 333. WATER MAINS SHALL CROSS OVER SANITARY SEWERS WITH A 18" MINIMUM CLEARANCE BETWEEN OUTSIDE DIAMETERS OF PIPE WITH ALL PIPE JOINTS EQUIDISTANT FROM CROSSING. HORIZONTAL SEPARATION BETWEEN WATER MAINS AND SANITARY SEWERS IN PARALLEL INSTALLATIONS SHALL BE 10'. MAINTAIN 12" MINIMUM VERTICAL DISTANCE FOR ALL OTHER UTILITY CROSSINGS AND 12" HORIZONTAL PARALLEL DISTANCE. IN CASES WHERE IT IS NOT POSSIBLE TO MAINTAIN THE MINIMUM 10' HORIZONTAL SEPARATION, THE WATER MAIN SHALL BE LAID ON A SEPARATE SHELF IN THE TRENCH 18" INCHES ABOVE THE SEWER.

LEGEND

PROPERTY LINE	----
CONCRETE SIDEWALK SURFACING	
ASPHALT SURFACING	

GRADING LABEL LEGEND

SPOT ELEVATION	XX.XX	XX	DESCRIPTION LISTED BELOW.
	DS		DOOR SILL
	EX		EXISTING GRADE
	FF		FINISHED FLOOR ELEVATION
	LP		LOW POINT
	SW		SIDEWALK
	TC		TOP OF CURB
	TP		TOP OF PAVEMENT

LEGEND

EXISTING CONTOUR MINOR	-----102-----
EXISTING CONTOUR MAJOR	-----100-----
PROPOSED CONTOUR MINOR	-----102-----
PROPOSED CONTOUR MAJOR	-----100-----
GRADE BREAK	-----GB-----GB-----
SANITARY SEWER LINE	-----SS-----SS-----
WATER LINE	-----W-----W-----W-----
STORM LINE	=====

LABEL LEGEND

PIPE LABELS

UTILITY LENGTH	-----
UTILITY SIZE	-----
XXLF - XX" XX	UTILITY TYPE
S=X.XX%	SLOPE (WHERE APPLICABLE)

STRUCTURE LABELS

UTILITY TYPE (FP= FIRE PROTECTION, S=SANITARY, SD=STORM DRAINAGE, W=WATER)	-----
STRUCTURE TYPE (SEE BELOW)	-----
XX XX-XX	ID NUMBER (WHERE APPLICABLE)
RIM=XX.XX	
IE IN=XX.X	STRUCTURE INFO (WHERE APPLICABLE)
IE OUT=XX.X	

STRUCTURE TYPES

TYPE	DESCRIPTION
BF	REDUCED PRESSURE BACKFLOW ASSEMBLY PER DETAIL 11/C4.0
CB	CATCH BASIN PER DETAIL 13/C4.0
GI	GREASE INTERCEPTOR PER DETAIL G12-GGI-2500/C4.2
RD	ROOF DRAIN CONNECTION
WM	WATER METER PER CITY DETAIL 309/C4.1

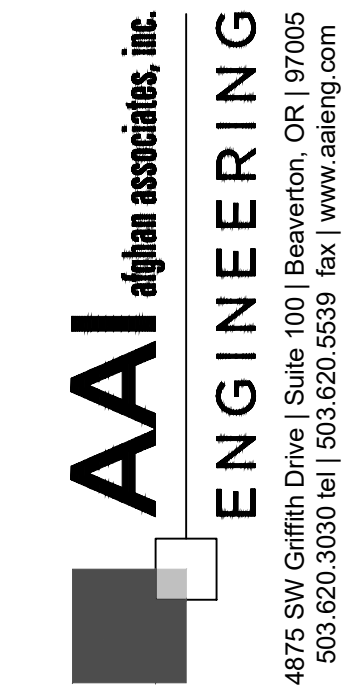
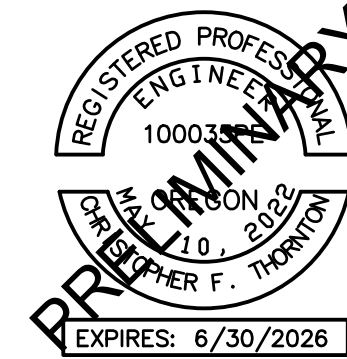

POPEYES WOODBURN

1600 MT HOOD AVE
WOODBURN, OR

SHEET TITLE

GENERAL NOTES

DATE: 09/27/24

DRAWN: AMW

CHECKED: JMS

REVISIONS:

AAI ENGINEERING INC.
2024, ALL RIGHTS RESERVED

THESE DRAWINGS ARE THE PROPERTY OF AAI ENGINEERING INC. AND ARE NOT TO BE USED OR REPRODUCED IN ANY MANNER, EXCEPT WITH THE PRIOR WRITTEN PERMISSION OF AAI ENGINEERING INC.

SHEET NUMBER

C0.1

JOB NUMBER: A24112.10

LEGEND:

- FOUND MONUMENT
- DECIDUOUS TREE EXTENTS OF DRIPLINE SHOWN, SPECIES AND DIA AS NOTED
- EVERGREEN TREE EXTENTS OF DRIPLINE SHOWN, SPECIES AND DIA AS NOTED
- BUSH, SPECIES AND DIA AS NOTED
- POWER POLE
- FIRE HYDRANT
- WATER VALVE
- CATCH BASIN
- STORM DRAIN MANHOLE
- SANITARY SEWER MANHOLE
- LIGHT POLE
- POWER BOX
- POWER VAULT
- POWER SIGNAL BOX
- SIGN
- LIGHT SIGNAL
- SD — UNDERGROUND STORM DRAIN PIPE
- PH — WATER LINE LOCATE
- SS — PHONE LINE LOCATE
- OHP — SEWER LINE LOCATE
- UGP — OVERHEAD POWER LINE
- UGP — UTILITY LOCATE
- UGP — UNDERGROUND POWER LINE
- (E) CONCRETE
- (E) PAVEMENT

ABBREVIATIONS LEGEND:

- (E) — EXISTING
- CONC — CONCRETE
- CB — CATCH BASIN
- FD — FOUND
- IR — IRON ROD
- MH — MANHOLE
- PP — PARTITION PLAT
- R/W — RIGHT-OF-WAY
- SS — SANITARY
- SEWER — STORM DRAIN
- SD — WITH
- W/ — YELLOW
- PLASTIC CAP

SHEET TITLE

EXISTING
CONDITIONS

DATE: 09/27/24

DRAWN: AMW

CHECKED: JMS

REVISIONS:

© AAI ENGINEERING INC.
2024. ALL RIGHTS RESERVED

THESE DRAWINGS ARE THE
PROPERTY OF AAI ENGINEERING INC.
AND ARE NOT TO BE USED OR
REPRODUCED IN ANY MANNER
EXCEPT WITH THE PRIOR WRITTEN
PERMISSION OF AAI ENGINEERING INC.

SHEET NUMBER

C0.2

JOB NUMBER: A24112.10

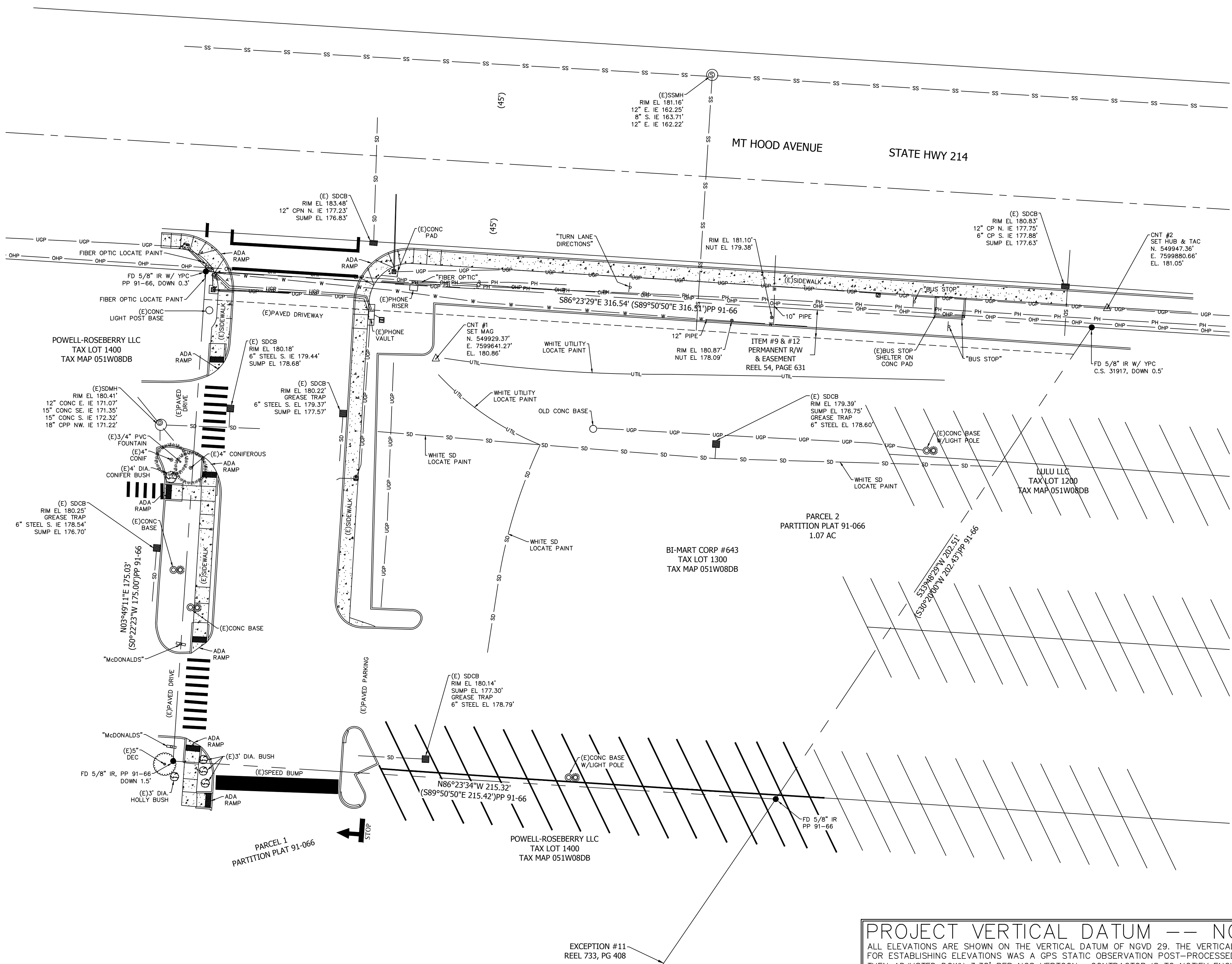

PROJECT VERTICAL DATUM -- NGVD 29

ALL ELEVATIONS ARE SHOWN ON THE VERTICAL DATUM OF NGVD 29. THE VERTICAL BENCHMARK USED FOR ESTABLISHING ELEVATIONS WAS A GPS STATIC OBSERVATION POST--PROCESSED USING OPUS AND THEN ADJUSTED DOWN 3.38' PER NGS VERTCON. CONTRACTOR IS TO NOTIFY ENGINEER/SURVEYOR TWO WORKING DAYS PRIOR TO DISTURBING EXISTING SURVEY MONUMENT(S). SURVEYOR IS TO RESTORE PER COUNTY SURVEYOR REQUIREMENTS AND ORS 209.150.

ATTENTION: OREGON LAW REQUIRES YOU TO FOLLOW RULES ADOPTED BY THE OREGON UTILITY NOTIFICATION CENTER. THOSE RULES ARE SET FORTH IN OAR 952-001-0010 THROUGH OAR 952-001-0090. YOU MAY OBTAIN COPIES OF THE RULES BY CALLING THE CENTER. (NOTE: THE TELEPHONE NUMBER FOR THE OREGON UTILITY NOTIFICATION CENTER IS (503) 232-1987).

THE LOCATION AND DESCRIPTIONS OF EXISTING UTILITIES SHOWN ON THE DRAWINGS ARE COMPILED FROM AVAILABLE RECORDS AND/OR FIELD SURVEYS. THE ENGINEER OR UTILITY COMPANIES DO NOT GUARANTEE THE ACCURACY OR THE COMPLETENESS OF SUCH RECORDS. CONTRACTOR SHALL FIELD VERIFY LOCATIONS OF ALL EXISTING UTILITIES PRIOR TO CONSTRUCTION.

NORTH

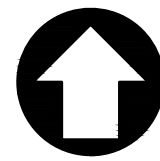

GRAPHIC SCALE



(IN FEET)
1 inch = 20 feet

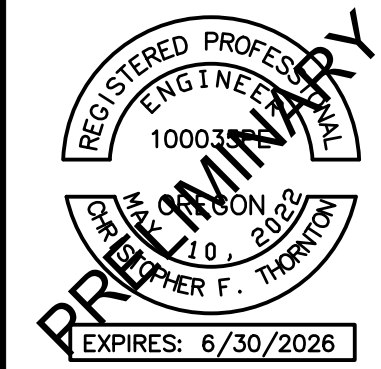

AAI ajian associates, inc.
ENGINEERING
4875 SW Griffin Drive | Suite 100 | Beaverton, OR 97005
503.820.3830 tel | 503.820.5539 fax | www.aaiang.com

POPEYES WOODBURN
1600 MT HOOD AVE
WOODBURN, OR

SHEET TITLE
DEMOLITION PLAN
DATE: 09/27/24
DRAWN: AMW
CHECKED: JMS
REVISIONS:

© AAI ENGINEERING INC. 2024. ALL RIGHTS RESERVED.
THESE DRAWINGS ARE THE PROPERTY OF AAI ENGINEERING INC. AND ARE NOT TO BE USED OR REPRODUCED IN ANY MANNER, EXCEPT WITH THE PRIOR WRITTEN PERMISSION OF AAI ENGINEERING INC.
SHEET NUMBER

C0.3

JOB NUMBER: A24112.10

SHEET NOTES

1. SEE SHEET C0.1 FOR GENERAL SHEET NOTES.
2. CONTRACTOR MAY STAGE WITHIN LIMITS OF DEMOLITION.
3. REMOVE ALL SITE COMPONENTS AND RECYCLE COMPONENTS AS REQUIRED IN THE SPECIFICATIONS.
4. ALL TRADE LICENSES AND PERMITS NECESSARY FOR THE PROCUREMENT AND COMPLETION OF THE WORK SHALL BE SECURED BY THE CONTRACTOR PRIOR TO COMMENCING DEMOLITION.
5. THE CONTRACTOR SHALL PRESERVE AND PROTECT FROM DAMAGE ALL EXISTING RIGHT-OF-WAY SURVEY MONUMENTATION DURING DEMOLITION. THE CONTRACTOR IS RESPONSIBLE FOR COORDINATING AND PAYING FOR THE REPLACEMENT BY A LICENSED SURVEYOR OF ANY DAMAGED OR REMOVED MONUMENTS.
6. PROTECT ALL ITEMS ON ADJACENT PROPERTIES AND IN THE RIGHT OF WAY INCLUDING BUT NOT LIMITED TO SIGNAL EQUIPMENT, PARKING METERS, SIDEWALKS, STREET TREES, STREET LIGHTS, CURBS, PAVEMENT AND SIGNS. CONTRACTOR SHALL BE RESPONSIBLE FOR RESTORING ANY DAMAGED ITEMS TO ORIGINAL CONDITION.
7. PROTECT STRUCTURES, UTILITIES, SIDEWALKS, AND OTHER FACILITIES IMMEDIATELY ADJACENT TO EXCAVATIONS FROM DAMAGES CAUSED BY SETTLEMENT, LATERAL MOVEMENT, UNDERMINING, WASHOUT AND OTHER HAZARDS.
8. SAWCUT STRAIGHT LINES IN SIDEWALK, AS NECESSARY.
9. CONTRACTOR IS RESPONSIBLE TO CONTROL DUST AND MUD DURING THE DEMOLITION PERIOD, AND DURING TRANSPORTATION OF DEMOLITION DEBRIS. ALL STREET SURFACES OUTSIDE THE CONSTRUCTION ZONE MUST BE KEPT CLEAN.
10. PROTECT ALL EXISTING UTILITY STRUCTURES AND UNDERGROUND MAINS TO REMAIN.
11. PROTECT ALL EXISTING VEGETATION TO REMAIN.

X PROTECTION NOTES

- 1 PROTECT EXISTING DRIVEWAY ENTRANCE
- 2 PROTECT EXISTING SIDEWALK
- 3 PROTECT EXISTING CURB
- 4 PROTECT EXISTING UTILITY
- 5 PROTECT EXISTING STRIPING
- 6 PROTECT EXISTING BUS STOP
- 7 PROTECT EXISTING ASPHALT
- 8 PROTECT EXISTING POLE

X DEMOLITION NOTES

- 1 SAWCUT AND REMOVE EXISTING ASPHALT
- 2 REMOVE EXISTING CURB
- 3 REMOVE EXISTING STRIPING
- 4 REMOVE EXISTING LIGHT POLE AND ASSOCIATED UTILITY
- 5 REMOVE EXISTING CATCH BASIN. SEE UTILITY PLAN FOR DETAILS.
- 6 REMOVE AND REROUTE EXISTING STORM LINE AROUND PROPOSED BUILDING. SEE UTILITY PLAN FOR DETAILS.
- 7 REMOVE EXISTING PUBLIC SIDEWALK. SEE HARDSCAPE PLAN FOR NEW LOCATION.

NOTE: CONTRACTOR TO POTHOLE AND VERIFY EXISTING CONDITIONS PRIOR TO STARTING CONSTRUCTION OR ORDERING MATERIALS. CONTRACTOR TO IDENTIFY POTENTIAL DISCREPANCIES BETWEEN WHAT IS SHOWN ON THESE PLANS AND WHAT IS IN THE FIELD AND NOTIFY PROJECT ENGINEER IMMEDIATELY IF CONFLICTS EXIST.

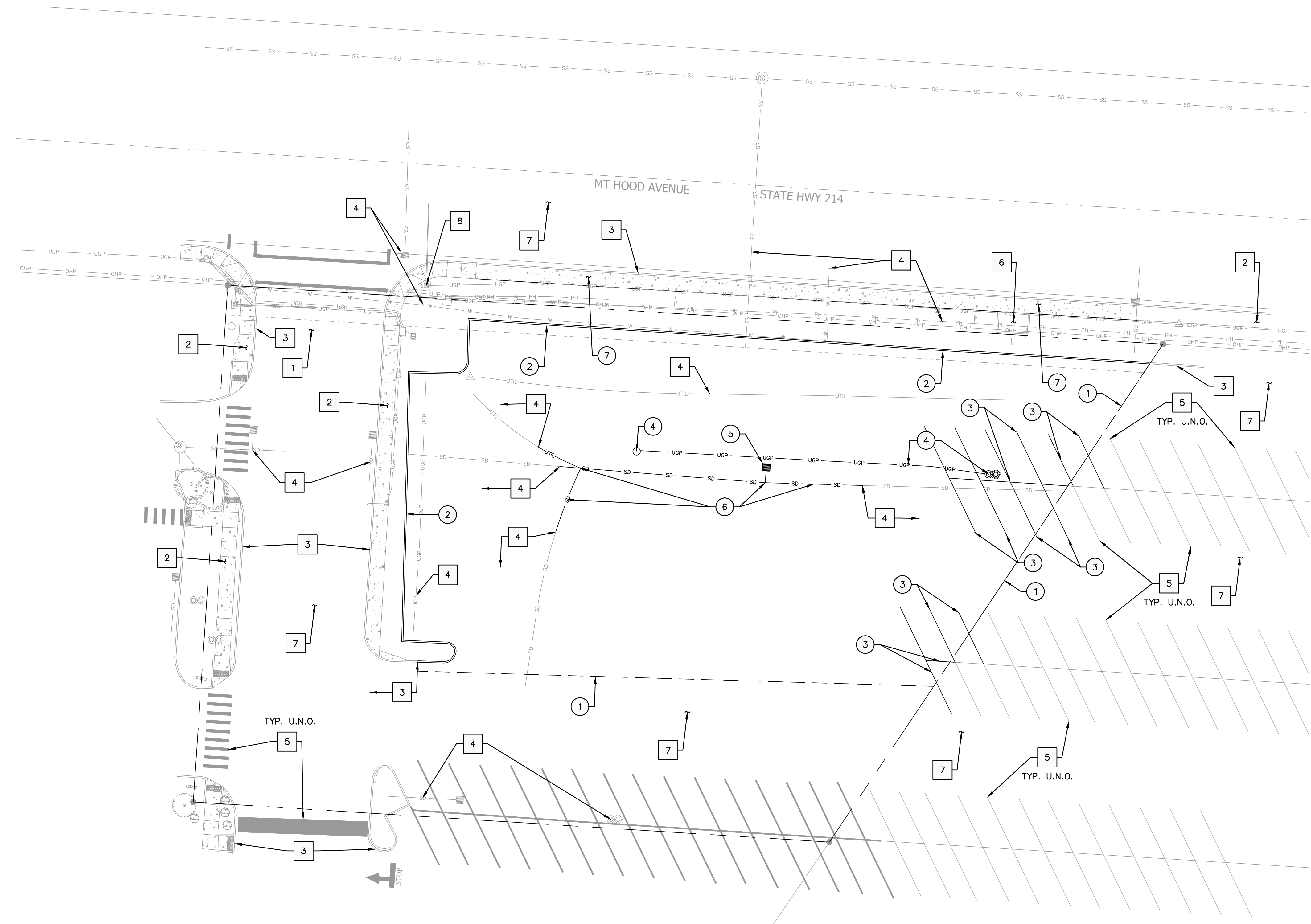
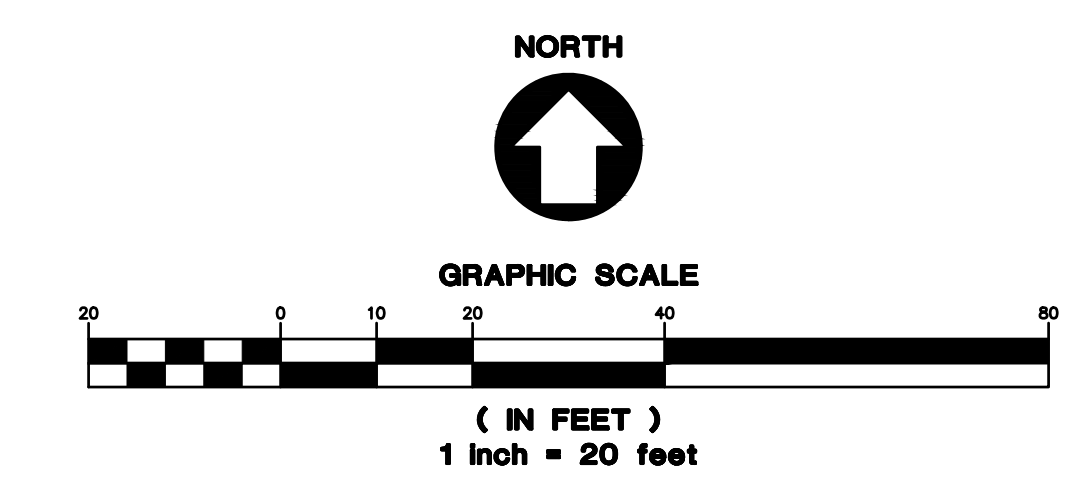

SHEET NOTES

- 1. SEE SHEET C0.1 FOR GENERAL SHEET NOTES.
- 2. SEE ARCHITECTURAL PLANS FOR ADDITIONAL SITE INFORMATION.
- 3. THE CONTRACTOR SHALL HAVE A FULL SET OF THE CURRENT APPROVED CONSTRUCTION DOCUMENTS INCLUDING ADDENDA ON THE PROJECT SITE AT ALL TIMES.
- 4. THE CONTRACTOR SHALL KEEP THE ENGINEER AND JURISDICTION INFORMED OF CONSTRUCTION PROGRESS TO FACILITATE SITE OBSERVATIONS AT REQUIRED INTERVALS. 24-HOUR NOTICE IS REQUIRED.

CONSTRUCTION NOTES

- 1. INSTALL CURB PER DETAIL 1/C4.0
- 2. INSTALL ASPHALT SURFACE PER DETAIL 2/C4.0
- 3. INSTALL CONCRETE SIDEWALK PER DETAIL 3/C4.0
- 4. INSTALL STRIPING. SEE ARCHITECTURAL PLANS FOR DETAILS.
- 5. INSTALL WHEELSTOP PER DETAIL 7/C4.0
- 6. INSTALL ADA RAMP TYPE 2 PER DETAIL 5/C4.0
- 7. INSTALL BOLLARD. SEE ARCHITECTURAL PLANS FOR DETAILS.
- 8. INSTALL ADA PARKING PER DETAIL 6/C4.0
- 9. INSTALL SIGN. SEE ARCHITECTURAL PLANS FOR DETAILS.
- 10. INSTALL BIKE PARKING. SEE ARCHITECTURAL PLANS FOR DETAILS.
- 11. INSTALL TRASH ENCLOSURE. SEE ARCHITECTURAL PLANS FOR DETAILS.
- 12. INSTALL SITE LIGHTING. SEE ELECTRICAL PLANS FOR DETAILS.
- 13. INSTALL ADA RAMP TYPE 3 PER DETAIL 12/C4.0
- 14. INSTALL ADA RAMP TYPE 1 PER DETAIL 4/C4.0
- 15. INSTALL STOP SIGN PER DETAIL 1/C4.1
- 16. INSTALL 6' PUBLIC SIDEWALK PER ODOT AND CITY STANDARDS.

LEGEND

PROPERTY LINE	---
CENTERLINE	---
CONCRETE SIDEWALK SURFACING	[Pattern]
ASPHALT SURFACING	[Pattern]

NOTE: CONTRACTOR TO POTHOLE AND VERIFY EXISTING CONDITIONS PRIOR TO STARTING CONSTRUCTION OR ORDERING MATERIALS. CONTRACTOR TO IDENTIFY POTENTIAL DISCREPANCIES BETWEEN WHAT IS SHOWN ON THESE PLANS AND WHAT IS IN THE FIELD AND NOTIFY PROJECT ENGINEER IMMEDIATELY IF CONFLICTS EXIST.

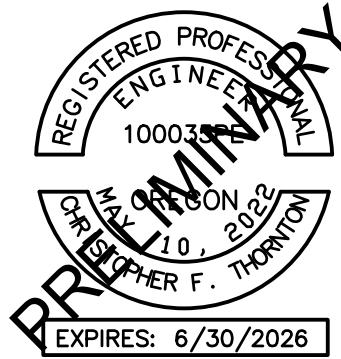

AAI ajghar associates, inc.
ENGINEERING
4875 SW Griffin Drive | Suite 100 | Beaverton, OR 97005
503.820.3030 | 503.820.5539 | www.aaieng.com

POPEYES WOODBURN

1600 MT HOOD AVE
WOODBURN, OR

SHEET TITLE

HARDSCAPE
PLAN

DATE: 09/27/24

DRAWN: AMW

CHECKED: JMS

REVISIONS:

AAI ENGINEERING INC.
2024. ALL RIGHTS RESERVED

THESE DRAWINGS ARE THE
PROPERTY OF AAI ENGINEERING INC.
AND ARE NOT TO BE USED OR
REPRODUCED IN ANY MANNER,
EXCEPT WITH THE PRIOR WRITTEN
PERMISSION OF AAI ENGINEERING INC.

SHEET NUMBER

JOB NUMBER: A24112.10

C1.0

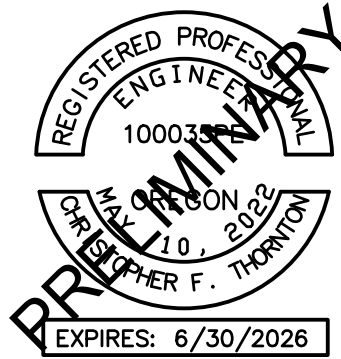

AAI ajghn associates, inc.
ENGINEERING
4875 SW Griffin Drive | Suite 100 | Beaverton, OR 97005
503.820.3630 tel | 503.820.5539 fax | www.aaieng.com

POPEYES WOODBURN
1600 MT HOOD AVE
WOODBURN, OR

SHEET TITLE

GRADING PLAN

DATE: 09/27/24

DRAWN: AMW

CHECKED: JMS

REVISIONS:

© AAI ENGINEERING INC. 2024. ALL RIGHTS RESERVED.

THESE DRAWINGS ARE THE PROPERTY OF AAI ENGINEERING INC. AND ARE NOT TO BE USED OR REPRODUCED IN ANY MANNER, EXCEPT WITH THE PRIOR WRITTEN PERMISSION OF AAI ENGINEERING INC.

SHEET NUMBER

JOB NUMBER: A24112.10

SHEET NOTES

1. SEE SHEET C0.1 FOR GENERAL SHEET NOTES.
2. CURB HEIGHTS ARE 6" UNLESS NOTED OTHERWISE.
3. LANDINGS ON ACCESSIBLE ROUTES SHALL NOT EXCEED 2% IN ANY DIRECTION.
4. ALL ACCESSIBLE ROUTES SHALL COMPLY WITH CURRENT ADA ACCESSIBILITY GUIDELINES FOR BUILDING AND FACILITIES (ADAAAG).
5. ALL WALKWAYS FROM ACCESSIBLE UNITS ARE DESIGNED TO NOT REQUIRE HANDRAILS. THEREFORE, RAMPS WITH SLOPES STEEPER THAN 5.0% AND LESS THAN 8.33% SHALL NOT EXCEED 0.5' RISE OR 6.0' LENGTH.
6. FINISH GRADES ARE TO BE BROUGHT TO WITHIN 0.08 FT IN 10 FT OF THE GRADES SHOWN AT SUBGRADE AND TO WITHIN 0.03 FT IN 10 FT AT FINISH GRADE. CONTRACTOR TO ALLOW FOR PLACEMENT OF REQUIRED TOPSOIL IN ROUGH GRADING.
7. GRADING ELEVATIONS AS SHOWN ON SITE AND LANDSCAPE PLANS ARE FINISHED GRADE WHICH INCLUDES SUBGRADE SOIL, TOPSOIL, SOIL AMENDMENTS, ROCKERY AND RUNOFF PROTECTION CONTRACTOR IS RESPONSIBLE TO COORDINATE GRADING WITH BOTH EXCAVATOR AND LANDSCAPE CONTRACTOR.

GRADING LABEL LEGEND

SPOT ELEVATION	
XX.XX	XX DESCRIPTION LISTED BELOW.
DS	DOOR SILL
EX	EXISTING GRADE
FF	FINISHED FLOOR ELEVATION
HP	HIGH POINT
SW	SIDEWALK
TC	TOP OF CURB
TP	TOP OF PAVEMENT

LEGEND

EXISTING CONTOUR MINOR	---	102	---
EXISTING CONTOUR MAJOR	---	100	---
PROPOSED CONTOUR MINOR	---	102	---
PROPOSED CONTOUR MAJOR	---	100	---
GRADE BREAK	---	GB	---

NOTE: CONTRACTOR TO POTHOLE AND VERIFY EXISTING CONDITIONS PRIOR TO STARTING CONSTRUCTION OR ORDERING MATERIALS. CONTRACTOR TO IDENTIFY POTENTIAL DISCREPANCIES BETWEEN WHAT IS SHOWN ON THESE PLANS AND WHAT IS IN THE FIELD AND NOTIFY PROJECT ENGINEER IMMEDIATELY IF CONFLICTS EXIST.

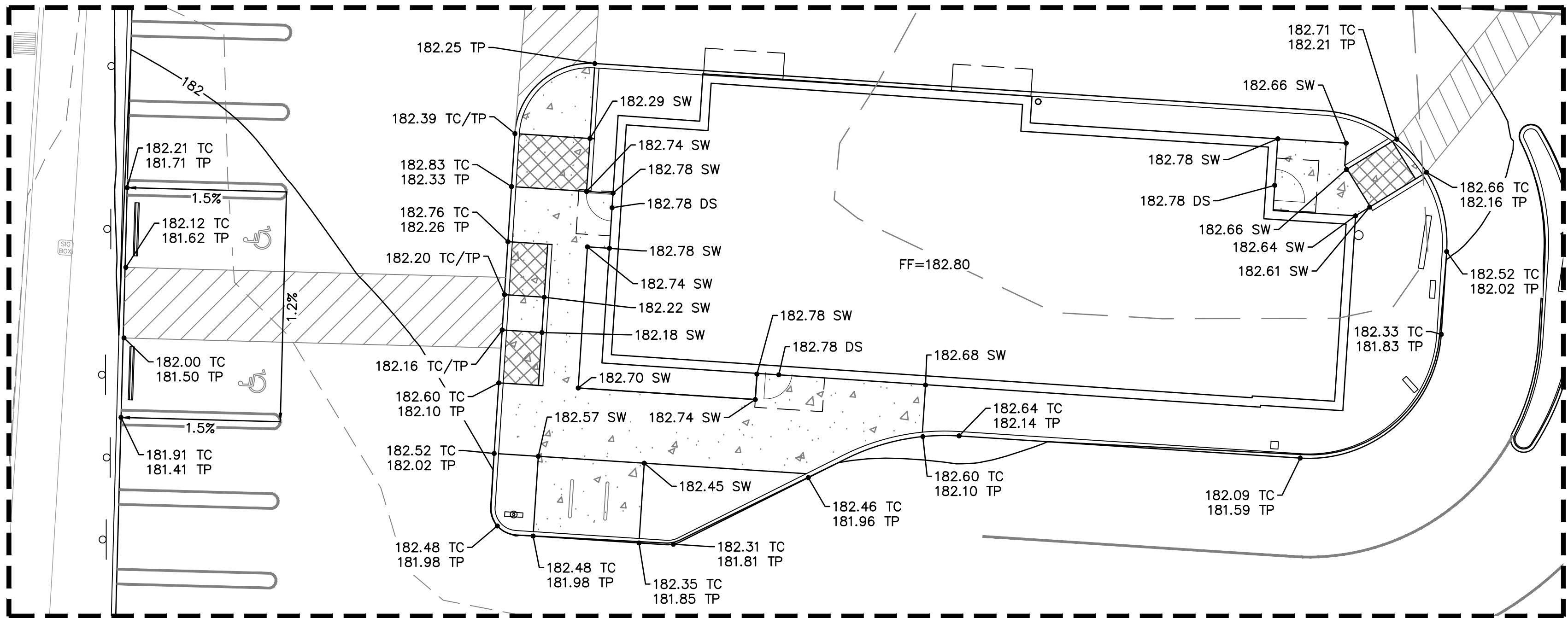

GRADING ENLARGEMENT
SCALE: 1" = 10'

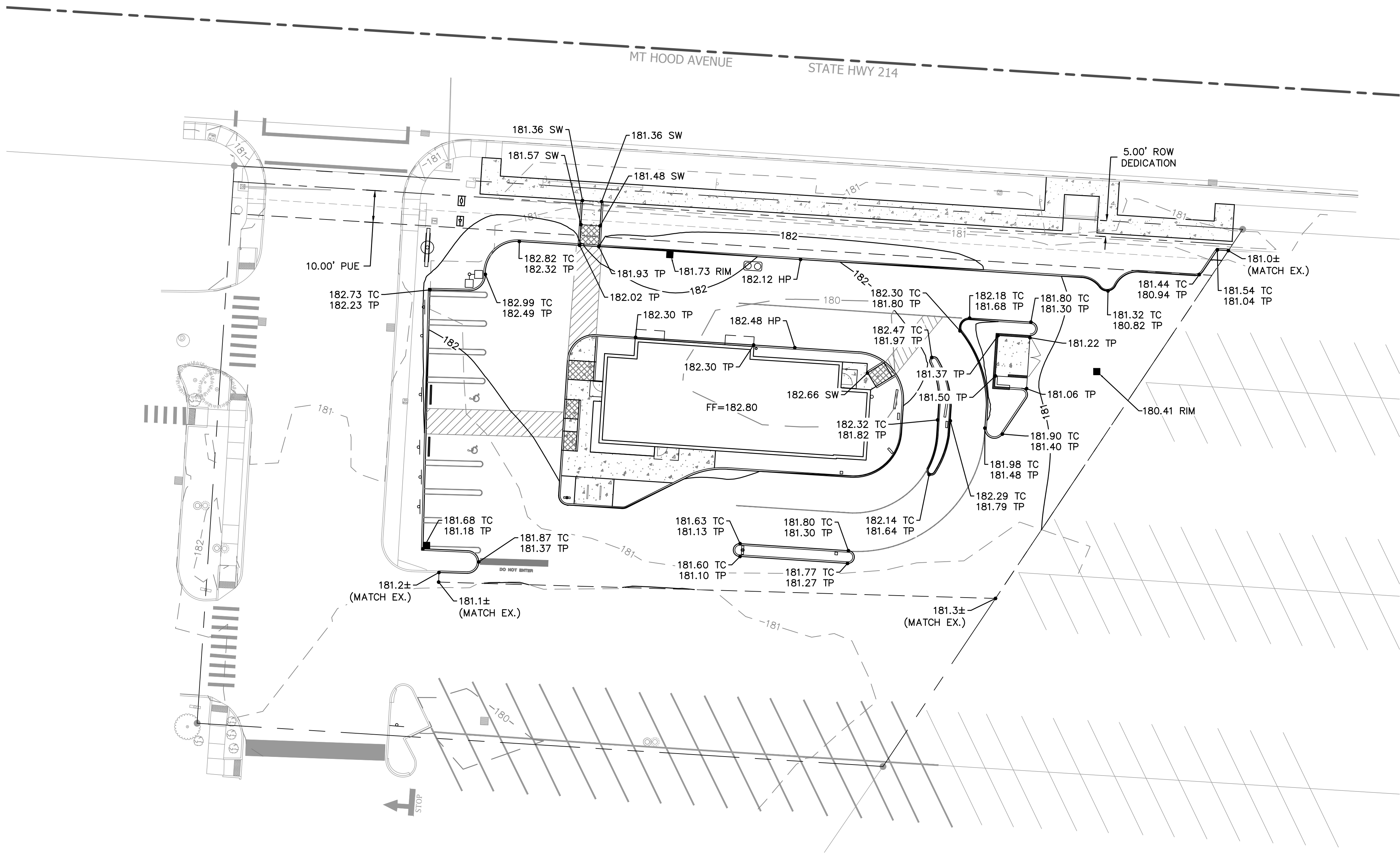

NORTH

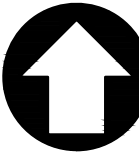

GRAPHIC SCALE



(IN FEET)
1 inch = 20 feet

03/05/24 - LAND USE SUBMITTAL

C2.0

JOB NUMBER: A24112.10

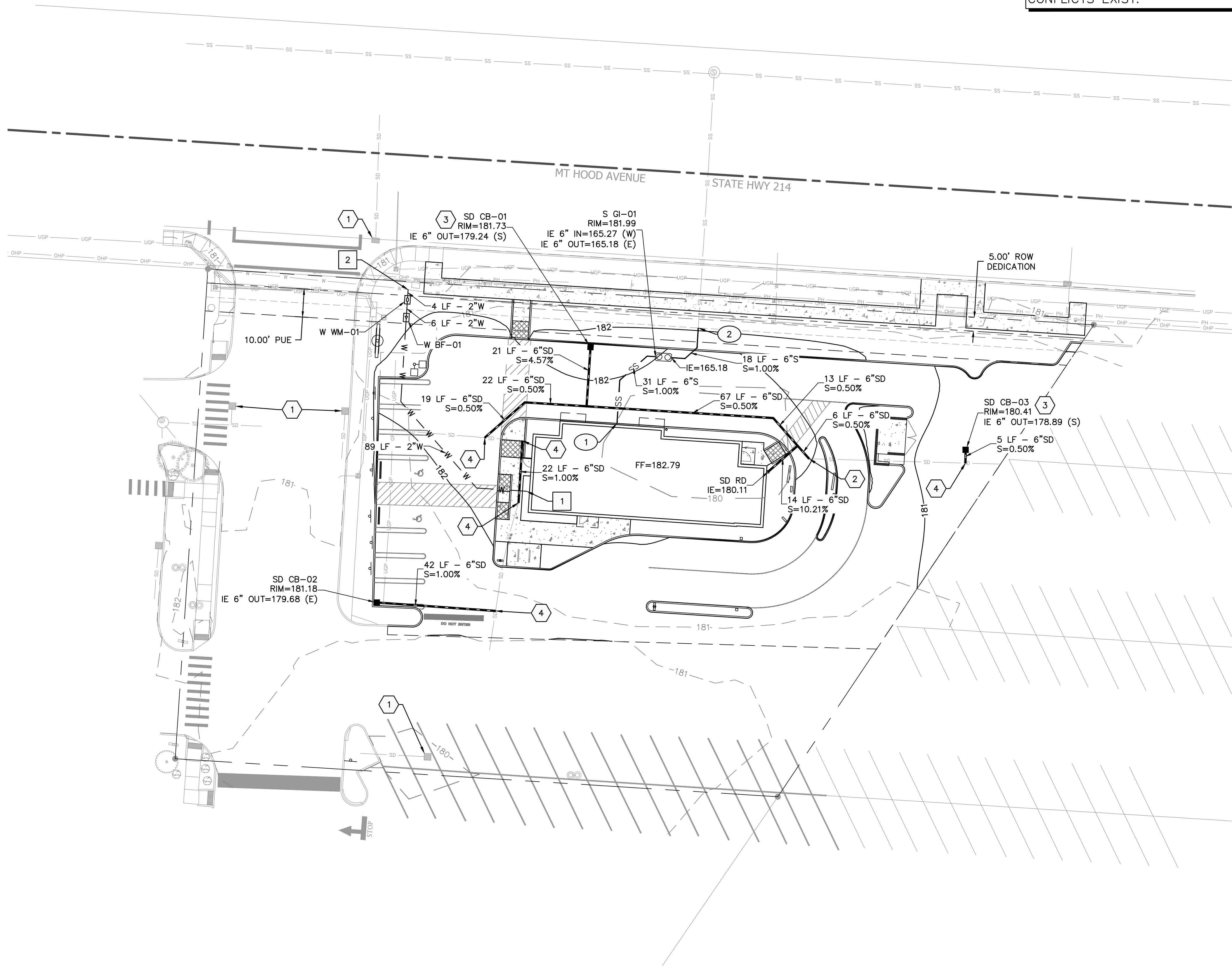

NOTE: CONTRACTOR TO POTHOLE AND VERIFY EXISTING CONDITIONS PRIOR TO STARTING CONSTRUCTION OR ORDERING MATERIALS. CONTRACTOR TO IDENTIFY POTENTIAL DISCREPANCIES BETWEEN WHAT IS SHOWN ON THESE PLANS AND WHAT IS IN THE FIELD AND NOTIFY PROJECT ENGINEER IMMEDIATELY IF CONFLICTS EXIST.

SHEET NOTES

- SEE SHEET C0.1 FOR GENERAL SHEET NOTES.
- STRUCTURES HORIZONTAL LOCATIONS AND PIPE INVERTS ARE BASED ON THE CENTER OF THE STRUCTURE.
- PIPE BEDDING AND BACKFILL UTILITIES SHALL BE DONE PER DETAIL 9/C4.0.
- INSTALL THRUST BLOCKS ON FIRE AND WATER LINES PER DETAIL 10/C4.0.
- ALL SANITARY PIPING SHALL BE PVC 3034 OR APPROVED EQUAL UNLESS NOTED OTHERWISE.
- THIS PLAN IS GENERALLY DIAGRAMMATIC. IT DOES NOT SHOW EVERY JOINT, BEND, FITTING, OR ACCESSORY REQUIRED FOR CONSTRUCTION.
- CLEAN OUTS SHALL BE INSTALLED IN CONFORMANCE WITH UPC CHAPTER SEVEN, SECTION 707 AND SECTION 719. THIS PLAN MAY NOT SHOW ALL REQUIRED CLEAN OUTS.
- DOMESTIC WATER AND FIRE LINES AND ACCESSORIES BETWEEN THE WATER METER AND THE BUILDING SHALL BE INSTALLED BY A LICENSED PLUMBER EMPLOYED BY A LICENSED PLUMBING CONTRACTOR.
- UTILITIES WITHIN FIVE FEET OF A BUILDING SHALL BE CONSTRUCTED OF MATERIALS APPROVED FOR INTERIOR USE AS DESCRIBED IN THE CURRENT EDITION OF THE UPC.
- INLETS AND OUTLETS TO ON-SITE MANHOLES SHALL HAVE FLEXIBLE CONNECTION NO CLOSER THAN 12" AND NO FARTHER THAN 36" FROM THE MANHOLE.
- CONTRACTOR TO VERIFY SANITARY AND WATER SIZING AND INVERTS WITH APPROVED PLUMBING PLANS PRIOR TO ORDERING MATERIALS OR BEGINNING CONSTRUCTION OF SAID UTILITIES.
- ALL STORM AND SANITARY FITTINGS TO BE ECCENTRIC FITTINGS UNLESS OTHERWISE NOTED.

LABEL LEGEND

PIPE LABELS

UTILITY LENGTH
UTILITY SIZE
XXLF - XX" XX ← UTILITY TYPE
S=X.XX% ← SLOPE (WHERE APPLICABLE)

STRUCTURE LABELS

UTILITY TYPE (FP= FIRE PROTECTION, S=SANITARY, SD=STORM DRAINAGE, W=WATER)
STRUCTURE TYPE (SEE BELOW)
XX XX-XX ← ID NUMBER (WHERE APPLICABLE)
RIM=XX.XX
IE IN=XX.X
IE OUT=XX.X ← STRUCTURE INFO (WHERE APPLICABLE)

STRUCTURE TYPES

TYPE DESCRIPTION
BF REDUCED PRESSURE BACKFLOW ASSEMBLY PER DETAIL 11/C4.0
CB CATCH BASIN PER DETAIL 13/C4.0
GI GREASE INTERCEPTOR PER DETAIL G12-GGI-2500/C4.1
RD ROOF DRAIN CONNECTION
WM WATER METER PER CITY DETAILS 5000-4 & 5050-1/C4.1

LEGEND

SANITARY SEWER LINE — SS — SS —
WATER LINE — W — W — W —
FIRE LINE — FP — FP — FP — FP —
STORM LINE —————

X STORM NOTES

- EXISTING CATCH BASIN TO REMAIN.
- CONNECT INTO EXISTING ONSITE 6" STORM PIPE.
- INSTALL CATCH BASIN AT NEW LOW POINT.
- CONNECT TO EXISTING ONSITE STORM PIPE (UNKNOWN DIAMETER).

X SANITARY NOTES

- SANITARY BUILDING POINT OF CONNECTION
- CONNECT TO EXISTING 8" SANITARY LATERAL ON-SITE. CONTRACTOR TO VERIFY EXISTING IE.

X WATER NOTES

- WATER BUILDING POINT OF CONNECTION
- WET TAP EXISTING 12" WATER MAIN.

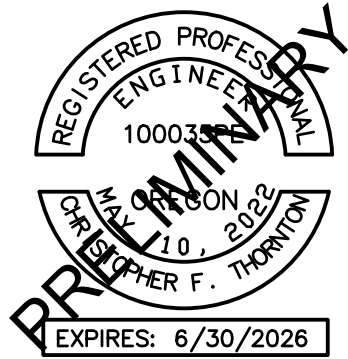
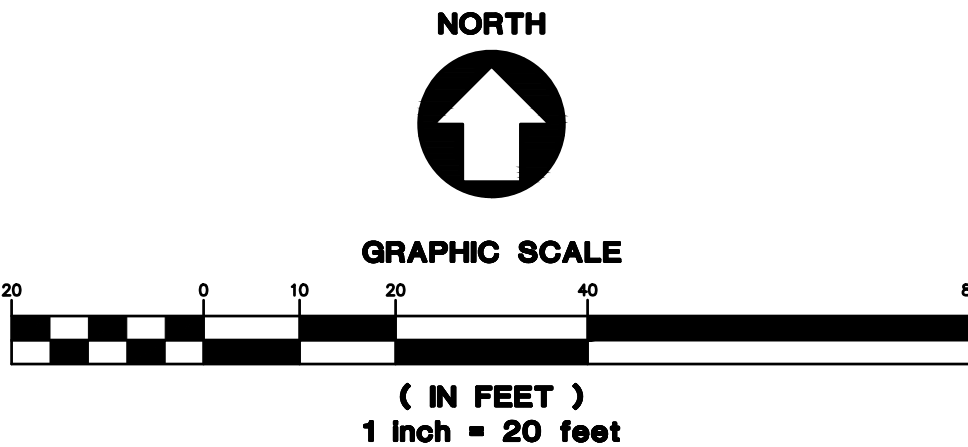

AAI ajian associates, inc.
ENGINEERING
4875 SW Griffin Drive | Suite 100 | Beaverton, OR 97005
503.620.3030 tel | 503.620.5539 fax | www.aaiang.com

POPEYES WOODBURN

1600 MT HOOD AVE
WOODBURN, OR

SHEET TITLE

UTILITY PLAN

DATE: 09/27/24

DRAWN: AMW

CHECKED: JMS

REVISIONS:

© AAI ENGINEERING INC. 2024. ALL RIGHTS RESERVED

THESE DRAWINGS ARE THE PROPERTY OF AAI ENGINEERING INC. AND ARE NOT TO BE USED OR REPRODUCED IN ANY MANNER, EXCEPT WITH THE PRIOR WRITTEN PERMISSION OF AAI ENGINEERING INC.

SHEET NUMBER

C3.0

JOB NUMBER: A24112.10

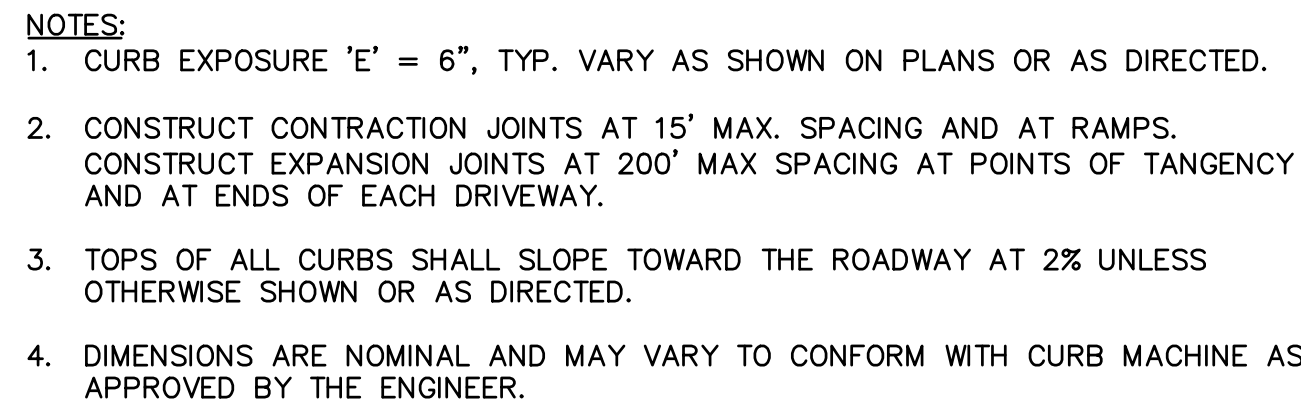

SCALE: NTS

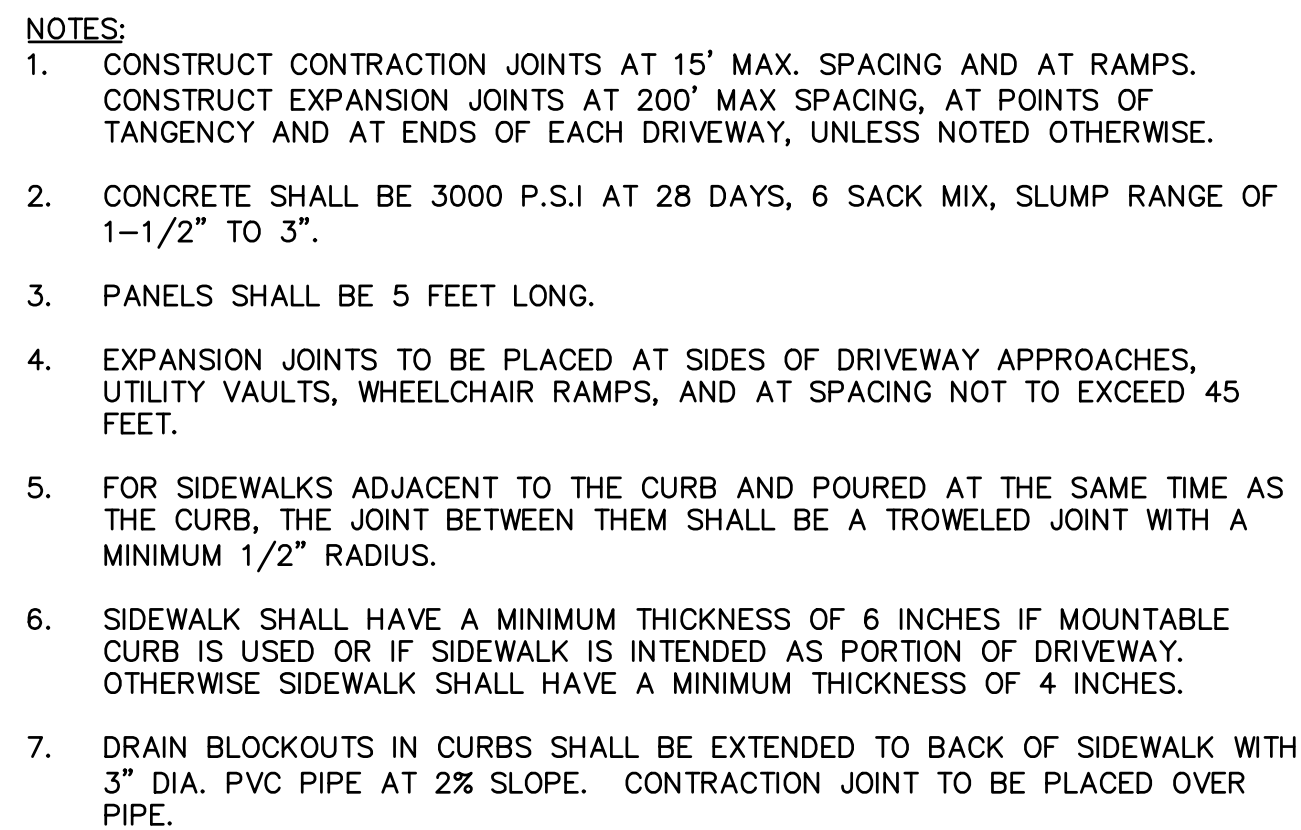

3 SCALE: NTS

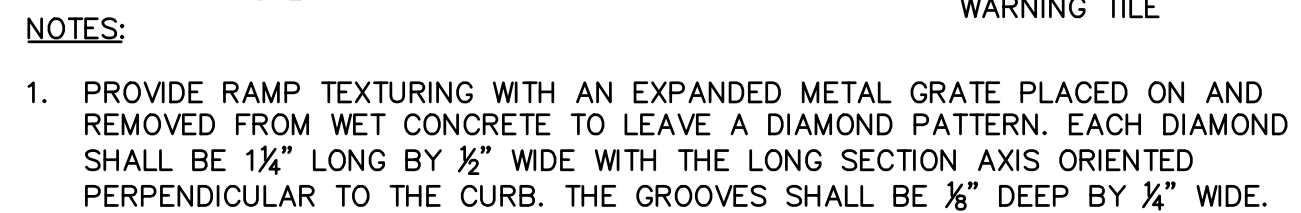

4 SCALE: NTS

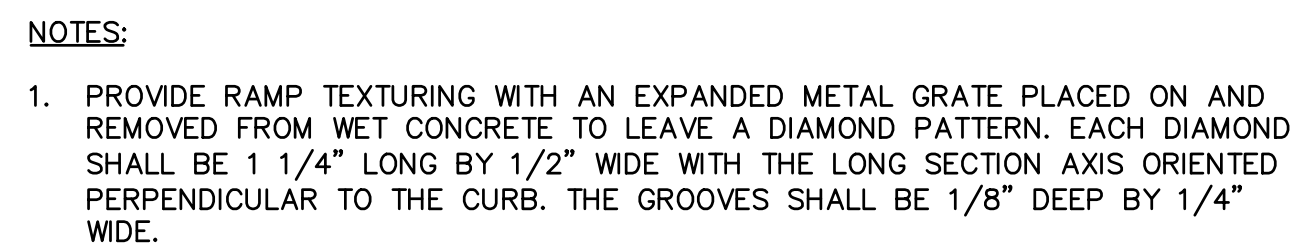

SCALE: NTS



SCALE: NTS

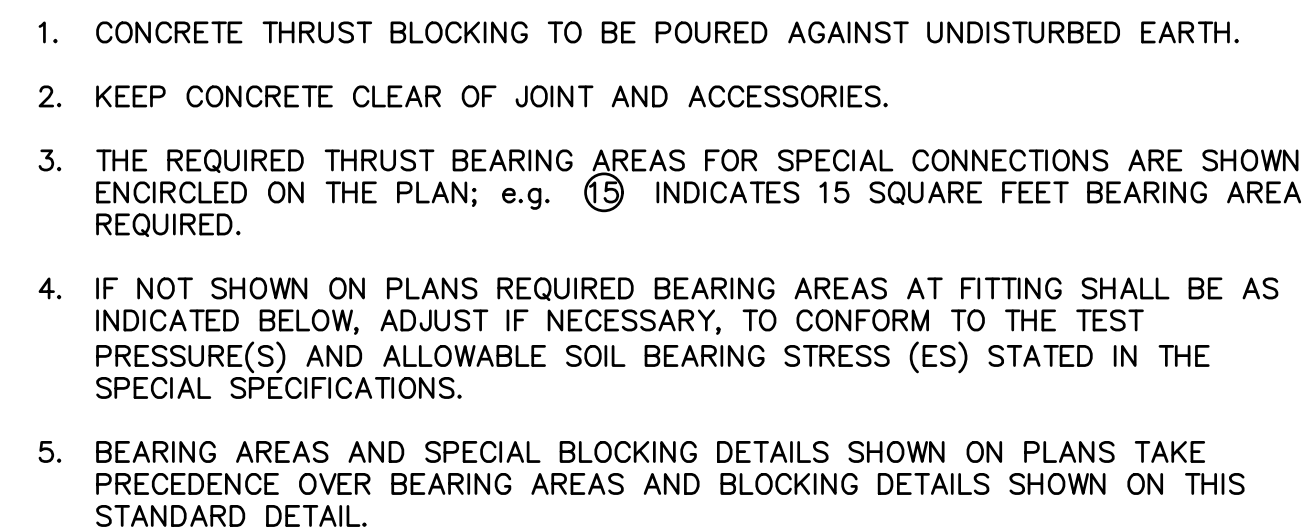
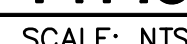

NOTE:
ABOVE BEARING AREAS BASED ON TEST PRESSURE OF 150 p.s.i. AND AN ALLOWABLE SOIL BEARING STRESS OF 2000 PSF. TO COMPUTE BEARING AREAS FOR DIFFERENT TEST PRESSURE AND SOIL BEARING STRESSES, USE THE FOLLOWING EQUATION: BEARING AREA = (TEST PRESSURE/150)X(2000/ SOIL BEARING STRESS)X(TABLE VALUE).

SCALE: NTS

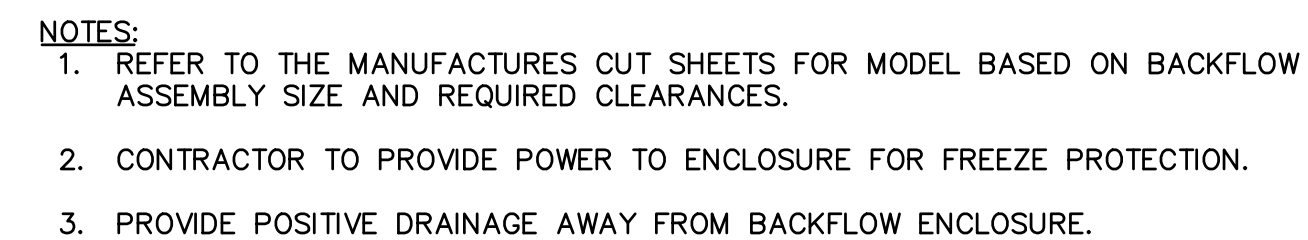

SCALE: NTS

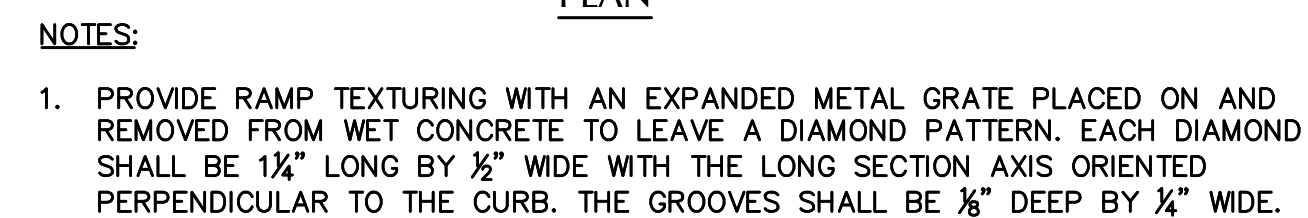

SCALE: NTS



13 SCALE: NTS

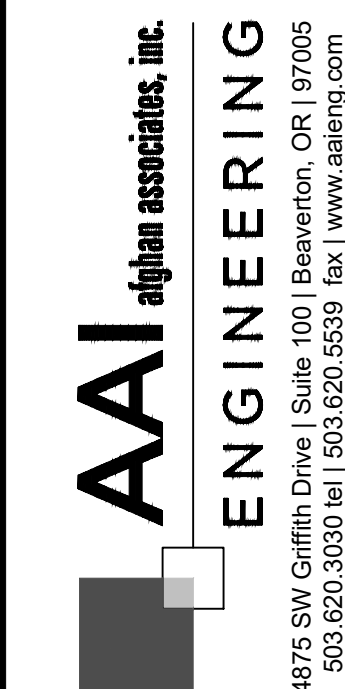

1600 MT HOOD AVE

SHEET TITLE

DETAILS

DATE: 09/27/24

DRAWN: AMW

CHECKED: JMS

REVISIONS:

© AAI ENGINEERING INC.
2024. ALL RIGHTS RESERVED.

THESE DRAWINGS ARE THE
PROPERTY OF AAI ENGINEERING INC.
AND ARE NOT TO BE USED OR
REPRODUCED IN ANY MANNER,
EXCEPT WITH THE PRIOR WRITTEN
PERMISSION OF AAI ENGINEERING INC.

SHEET NUMBER

JOB NUMBER: A24112.10

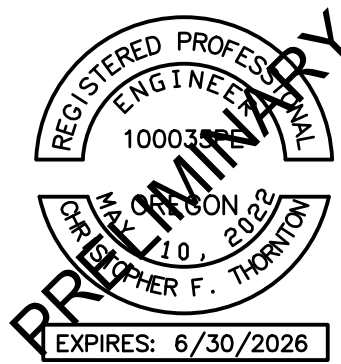

POPEYES WOODBURN

1600 MT HOOD AVE
WOODBURN, OR

SHEET TITLE

DETAILS

DATE: 09/27/24

DRAWN: AMW

CHECKED: JMS

REVISIONS:

© AAI ENGINEERING INC. 2024. ALL RIGHTS RESERVED

THESE DRAWINGS ARE THE PROPERTY OF AAI ENGINEERING INC. AND ARE NOT TO BE USED OR REPRODUCED IN ANY MANNER, EXCEPT WITH THE PRIOR WRITTEN PERMISSION OF AAI ENGINEERING INC.

SHEET NUMBER

C4.1

JOB NUMBER: A24112.10

BROOKS PRODUCTS		
	COVER	METER BOX
DIA.	MODEL NO.	
1"	No. 37-T CAST IRON COVER*	No. 37 MB-BODY*
2"	No. 65-TF STEEL COVER (FLUSH)*	No. 65 MB-BODY*
* OR APPROVED EQUAL		

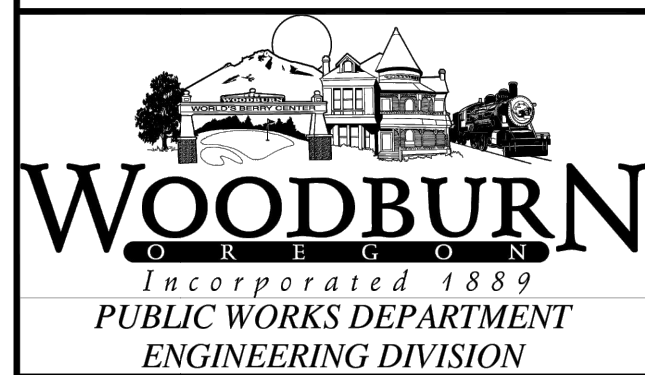
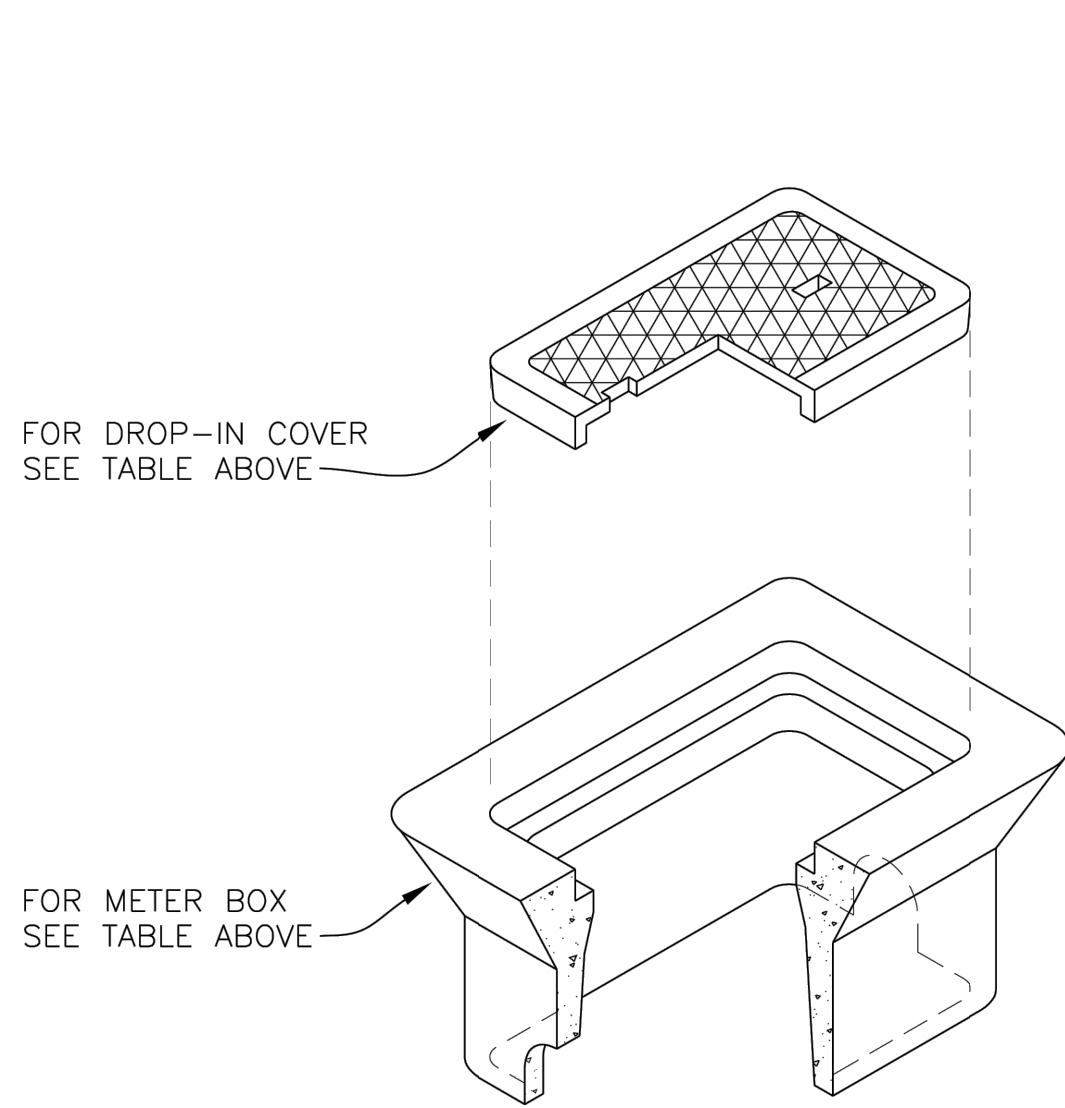

METER BOX

REV: FEB 2020
SCALE: NTS
DET No. 5050-1

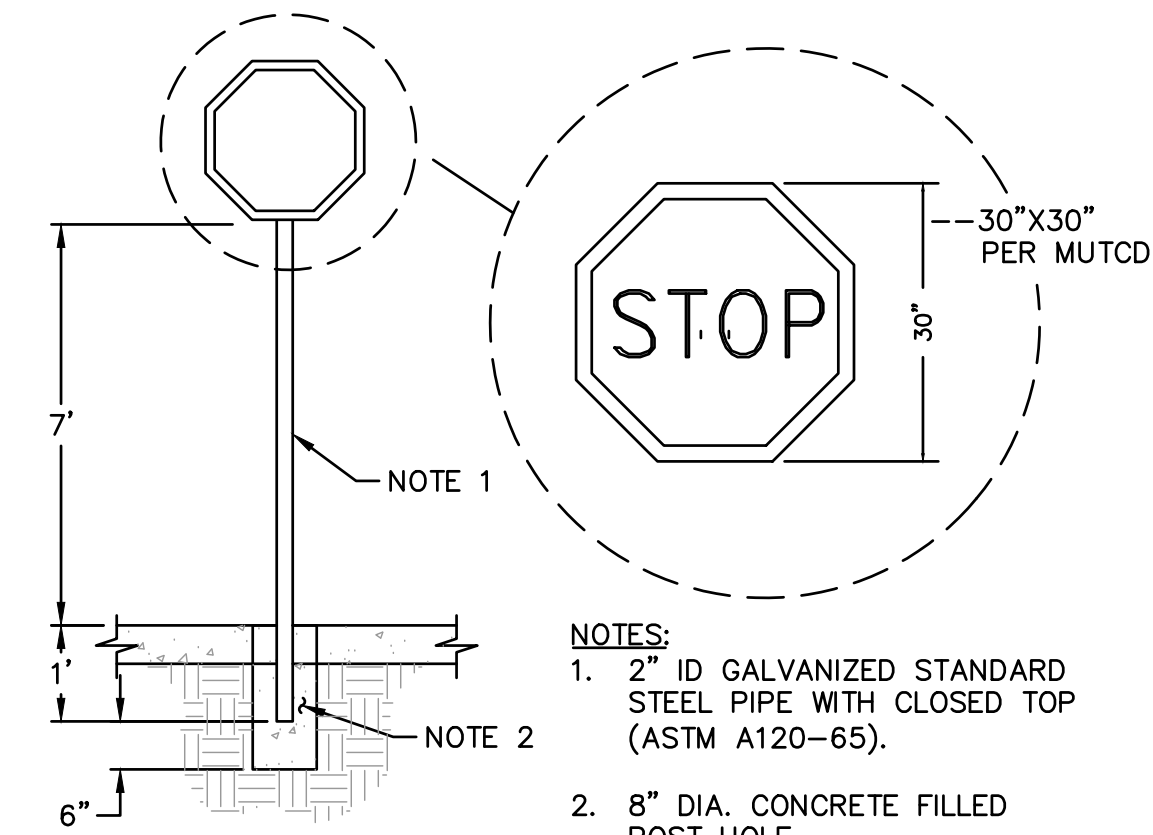

1 STOP SIGN
SCALE: NTS

- NOTES:
- 2" ID GALVANIZED STANDARD STEEL PIPE WITH CLOSED TOP (ASTM A120-65).
 - 8" DIA. CONCRETE FILLED POST HOLE.

FORD CO. MODEL		
	CORP STOP	ANGLE METER VALVE
DIA.	Model No.	
1"	F1000-4*	KV43-444W*
1.5"	FB500-6*	FV43-666W*
2"	FB500-7*	FV43-777W*
* OR APPROVED EQUAL		

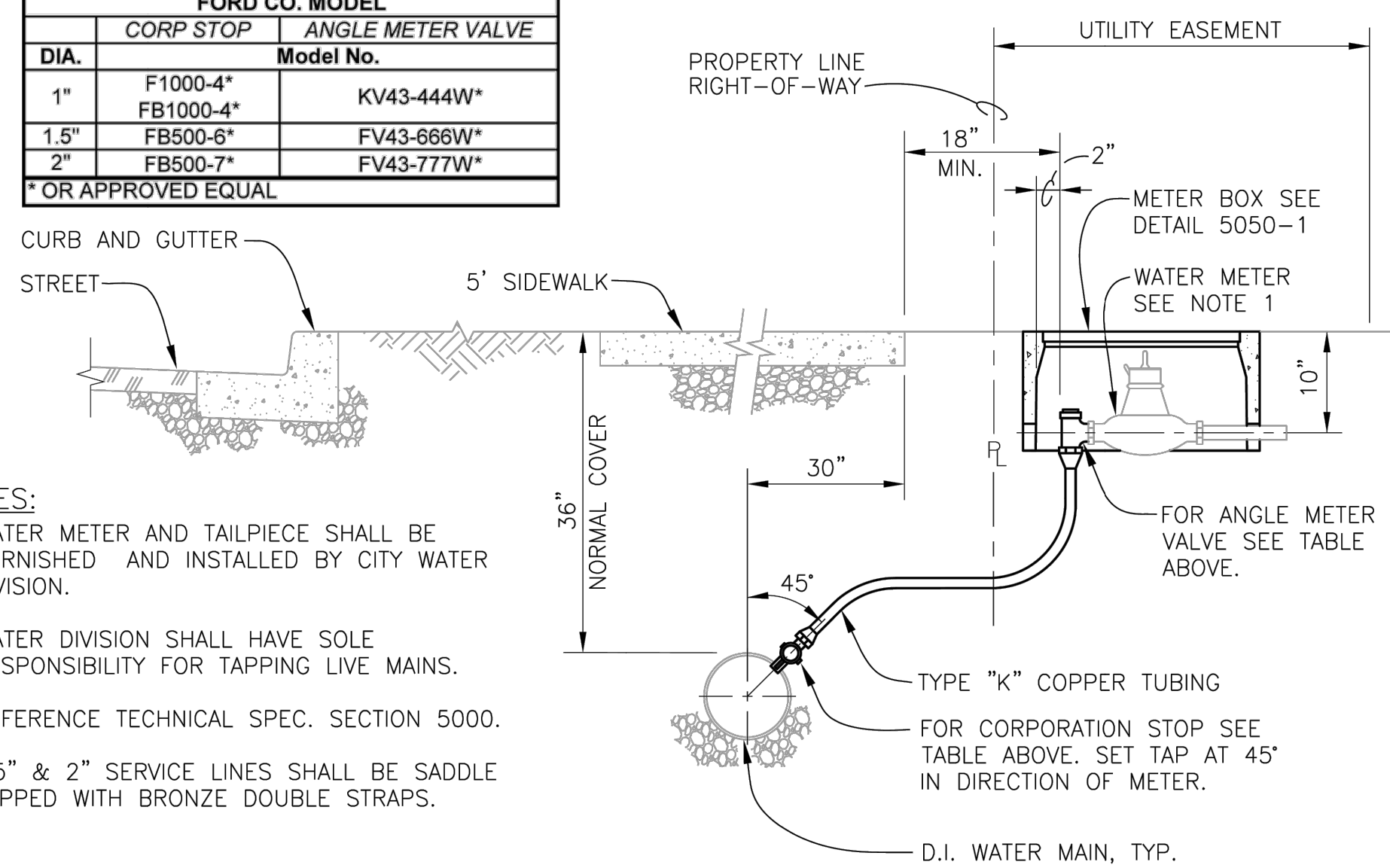

- NOTES:
- WATER METER AND TAILPIECE SHALL BE FURNISHED AND INSTALLED BY CITY WATER DIVISION.
 - WATER DIVISION SHALL HAVE SOLE RESPONSIBILITY FOR TAPPING LIVE MAINS.
 - REFERENCE TECHNICAL SPEC. SECTION 5000.
 - 1.5" & 2" SERVICE LINES SHALL BE SADDLE TAPPED WITH BRONZE DOUBLE STRAPS.

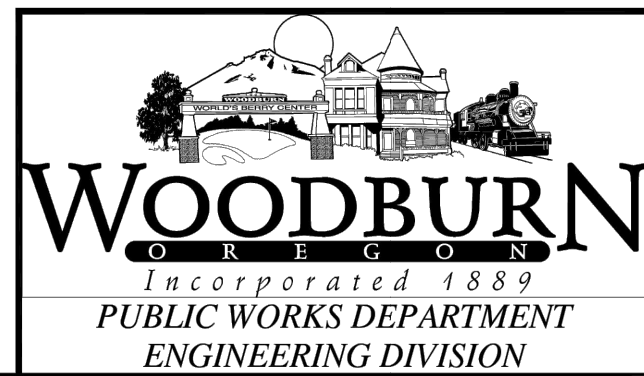

WATER SERVICE CONNECTION

REV: MAY 2011
SCALE: NTS
DET No. 5000-4

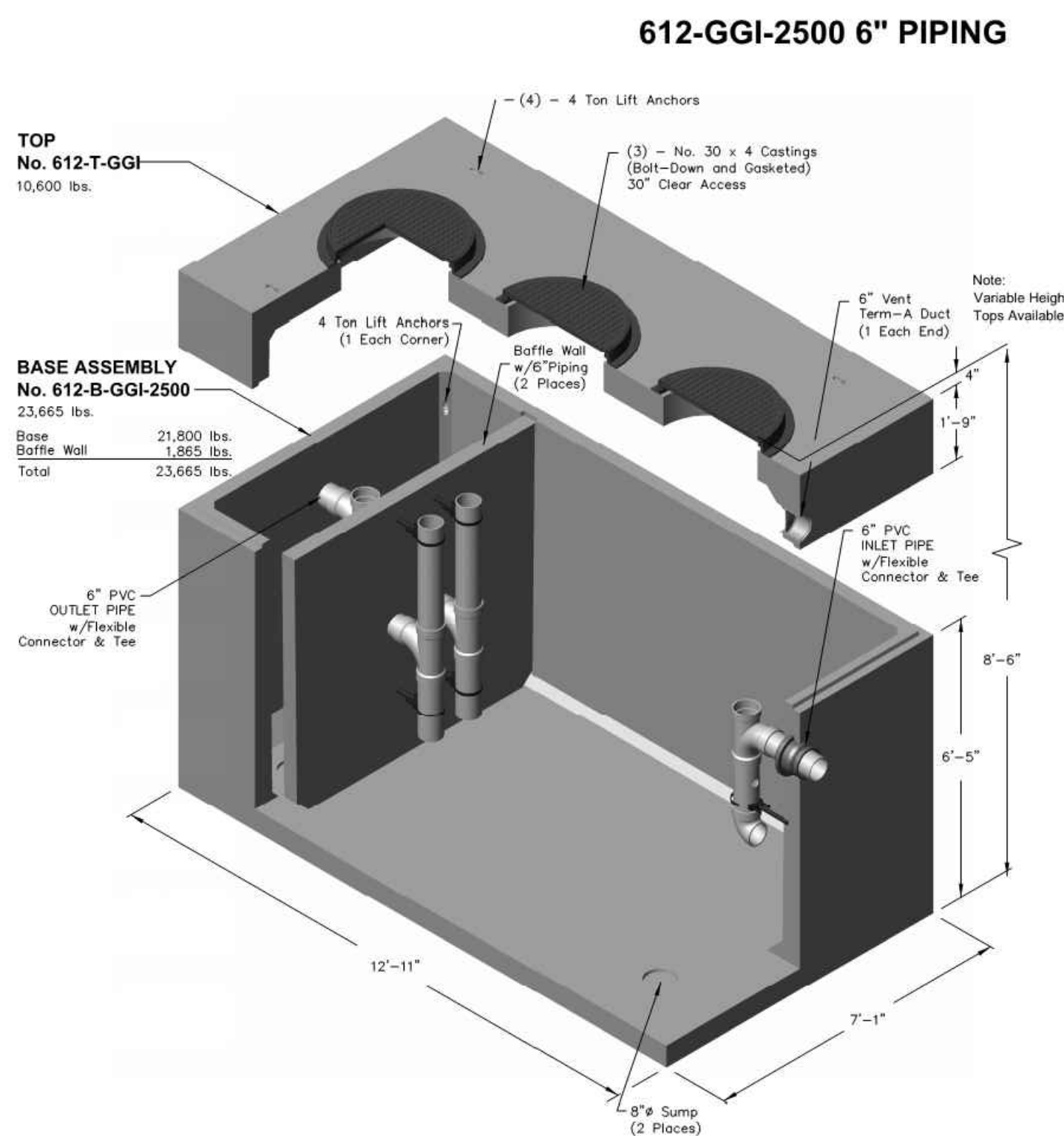

Note: Contractor is responsible for supplying crane to set vault.

Note: Designed for 0 to 5'-0" of Cover

612-GGI-2500		612-GGI-2500 GRAVITY GREASE INTERCEPTOR 2500 GALLON
File Name: 020-612GGI-2500		
Issue Date: 2018		
oldcastleprecast.com/wilsonville		

21.0

612-GGI-2500 6" PIPING

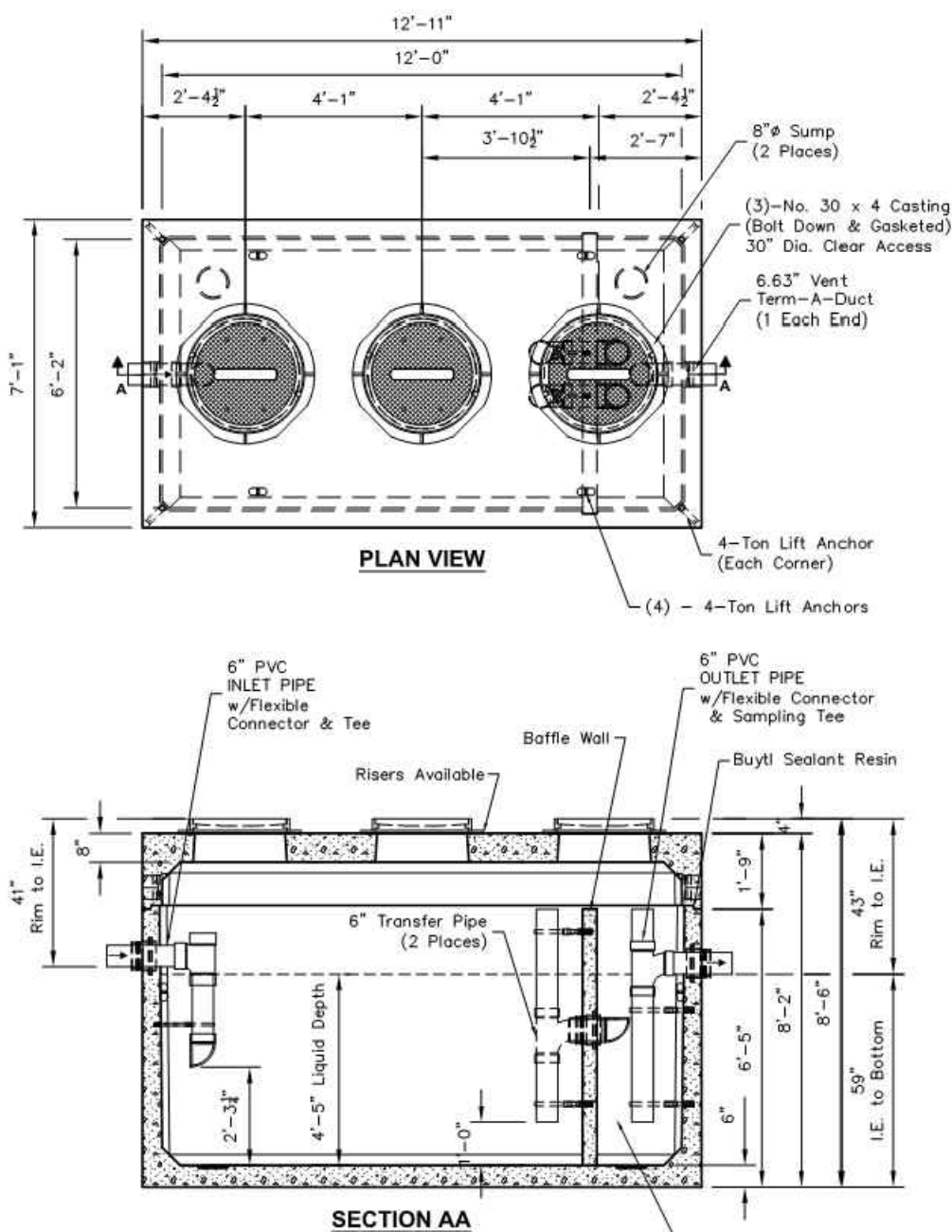

Gravity Grease Interceptor:
- Designed in accordance with IAPMO/ANSI Z1001, Manufactured per ASTM C1613
- Loading per ASTM D990 for AASHTO H20-44 vehicle loading and maximum soil cover of 5'-0"
- Maximum allowable DFUs (Drainage Fixture Units) = 307 (equivalent to 2,500 gallon size)
- Corrosion resistant plastic liner available to extend the life of the tank.
Manufacture's recommendations:
- Fill lift anchor pockets with grout.
- Ventilate each end to open atmosphere.
- Prior to "Start Up" of System, fill with clean water through inlet bay to bottom of transfer pipe (approx. one foot deep).
- Follow Regular Inspection, Cleaning, & Maintenance Schedule (See Clean Out & Maintenance Instructions).

612-GGI-2500		612-GGI-2500 GRAVITY GREASE INTERCEPTOR 2500 GALLON
File Name: 020-612GGI-2500		
Issue Date: 2018		
oldcastleprecast.com/wilsonville		

21.1