

7739Z Frame

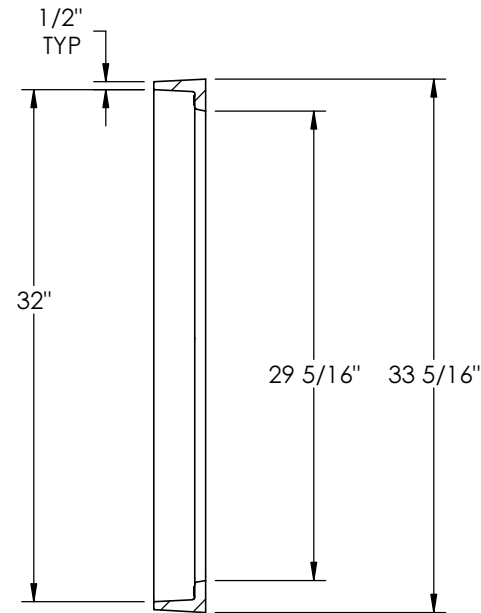

SECTION A-A

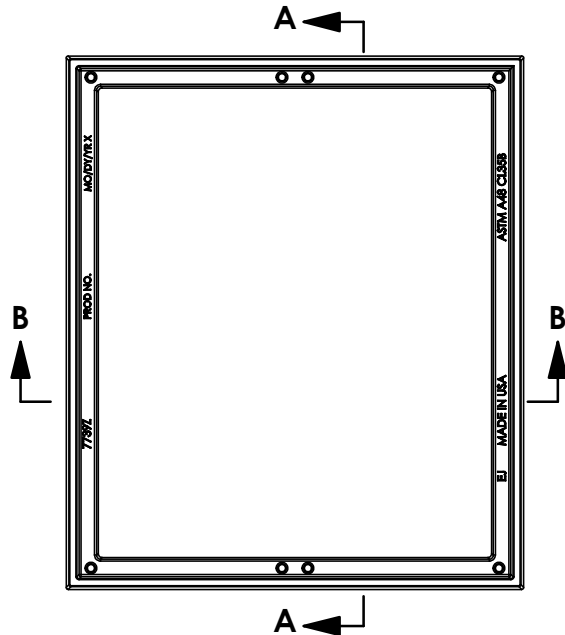
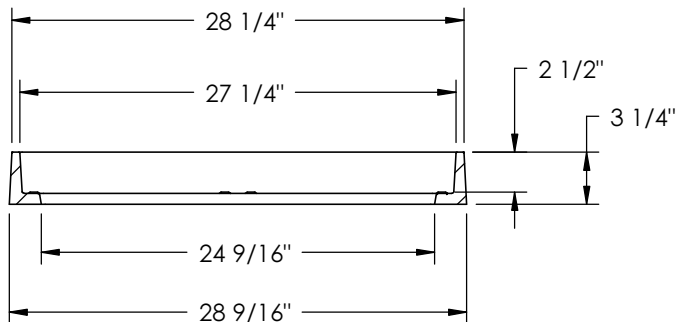

SECTION B-B

Product Number

00773911

Design Features

- Materials
Gray Iron (CL35B)
- Design Load
Heavy Duty
- Open Area
n/a
- Coating
Undipped
- √ Designates Machined Surface

Certification

- ASTM A48
-
- Country of Origin: USA

Drawing Revision

5/29/2008 Designer: DEW
7/29/2015 Revised By: DAE

Disclaimer

Weights (lbs/kg), dimensions (inches/mm) and drawings provided for your guidance. We reserve the right to modify specifications without prior notice.

CONFIDENTIAL: This drawing is the property of EJ Group, Inc. and embodies confidential information, registered marks, patents, trade secret information, and/or know how that is the property of EJ Group, Inc. Copyright © 2013 EJ Group, Inc. All rights reserved.

Contact

800 626 4653
ejco.com

7739M1 Grate

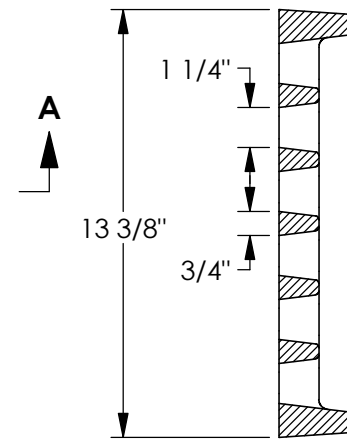
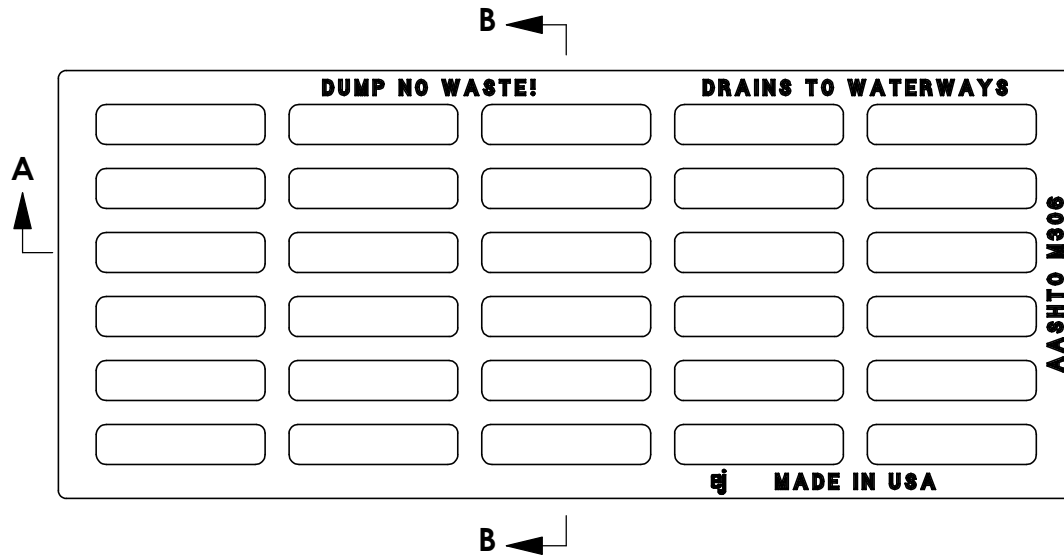

SECTION B-B

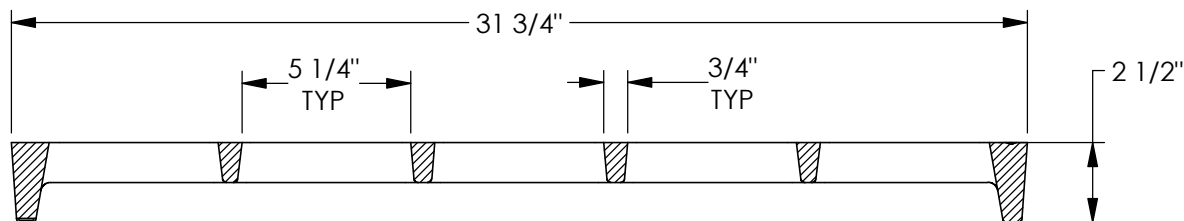

SECTION A-A

7739M1
ASTM A536
MO/DY/YR X
PROD NO.

Product Number

00773935

Design Features

- Materials
Ductile Iron (80-55-06)
- Load Rating
Heavy Duty
- Open Area
196 sq. inches
- Coating
Undipped
- √ Designates Machined Surface

Certification

- ASTM A536
-
- Country of Origin: USA

Drawing Revision

09/25/2007 Designer: SBB
08/21/2019 Revised By: DEF

Disclaimer

Weights (lbs/kg), dimensions (inches/mm) and drawings provided for your guidance. We reserve the right to modify specifications without prior notice.

CONFIDENTIAL: This drawing is the property of EJ Group, Inc. and embodies confidential information, registered marks, patents, trade secret information, and/or know how that is the property of EJ Group, Inc. Copyright © 2018 EJ Group, Inc. All rights reserved.

Contact

800 626 4653
ejco.com